

## Description

5           The invention relates to a flow meter for measuring the flow of fluids in a pipe or the like according to the preamble of patent claim 1.

          Flow meters can, for example, have two ultrasonic transducers, which are inserted as so-called "clip-on-solutions" at a distance from each other in a pipe section of the  
10 pipe, wherein both transducers act as emitter and receiver. The measuring signals are coupled obliquely through the pipe-section wall into the fluid.

          The flow speed can then be determined from the runtime of the measuring signals from the emitter to the receiver in a manner known per se. Such flow meters are  
15 described, for example, in the printed publications WO 2004/036151 A1 and DE 10 2005 057 888.

          The disadvantage of clip-on-flow meters is that the measuring signals penetrate the wall of the measuring channel, so that different measuring signals are obtained for  
20 different materials of which the measuring channel can be made, so that the influence of the material must be taken into account in the measuring signal evaluation.

          Furthermore, solutions are known having a measuring insert in which the ultrasonic transducers are accommodated. This measuring insert is inserted into a  
25 recess of a pipe section/measuring channel, wherein the actual measuring channel can also be a part of this measuring insert.

          Such a solution is disclosed, for example, in DE 101 20 355 A1, wherein the two ultrasonic transducers are arranged in the flow direction at a distance from each other  
30 and on opposite sides of the measuring channel.

          The documents EP 2 505 968 A1 and EP 2 639 559 A1 each disclose flow meters in which a measuring unit with two ultrasonic sensors is placed on a flange of the measuring channel. The sensors are set back relative to the measuring channel,

whereby the input and output of the signals takes place via a membrane-like partition wall that covers an opening of the measuring channel.

In EP 2 306 160 A1, a flow meter/flow counter is disclosed, in which the measuring insert accommodates the ultrasonic transducer and also forms the actual measuring channel. This measuring insert is attached to a tangential flange of a pipe section of a housing of the flow meter. A profile body forming the measuring channel immerses into a recess of the pipe section surrounded by the flange, which influences the streaming within the measurement area, and on which reflectors for the measuring signals are additionally provided. In this solution, the two ultrasonic transducers are arranged in a pot-shaped housing part of the measuring insert, which is closed towards the streaming and is immersed in it.

A similar solution is shown in DE 10 2010 020 338 A1 respectively EP 2 386 836 B1, which is based on it. In this embodiment, the measuring insert carries two ultrasonic transducers arranged in the streaming direction offset to each other, which are also accommodated in a pot-shaped housing part and which project into the measuring channel through an opening, which is surrounded by a flange, of a pipe section of a housing. The stream guidance within the measuring channel is determined by a housing insert which can be inserted from the front side of the housing and which also carries reflectors for the ultrasonic signals, so that the ultrasound is emitted by one of the ultrasonic transducers and reflected via the reflectors to the other ultrasonic transducer, which is located downstream, for example. Of course, the signal can also be guided in the reverse direction.

In the published publication EP 0 890 826 B1, a flow meter is described, in which a measuring insert is also attached to a tangential flange in the area of a pipe section of a housing. The measuring insert carries two ultrasonic transducers which are inserted into the recesses of a bottom of a housing part and are sealed there by means of a respective seal. The whole measuring insert is then sealed against the flange with another circumferential seal, which encompasses both ultrasonic transducers. In this embodiment, the measuring channel is also formed by the measuring insert, which is inserted into the pipe section of the housing through the recess encompassed by the flange.

Document DE 199 44 411 A1 discloses a flow meter in which an insert is formed in a measuring pipe by which the cross-section of the measuring pipe is formed to be elongated. Two ultrasonic transducers are arranged in an offset manner at opposite sides of the measuring channel in the direction of flow.

5

In EP 0 650 034 A1, a flow meter is described in which two ultrasonic transducers are also arranged in an offset manner to each other. A respective reflector is provided on the opposite side which is arranged at the inclined surfaces of the measuring channel.

10

In all solutions described above, the reflectors are formed diametrically with respect to the ultrasonic transducers, so that at least two reflectors must be provided in order to guide the ultrasonic signals.

15 In the flow meter according to EP 0 890 826 B1, the two ultrasonic transducers are each arranged in a sensor housing and project radially into the measuring channel so that the fluid flows around them.

20 US 2013/167 655 A1 and DE 10 2004 061 404 A1 both disclose flow meters in which two ultrasonic sensors are arranged in an inclined manner in a measuring housing, which is put on the measuring channel and which is open towards the measuring channel, so that turbulences might occur in the transition region to the measuring housing.

25 A disadvantage of such solutions is that either the ultrasonic transducers with their coupling element are arranged directly in the stream or the housing parts surrounding the ultrasonic transducers, e.g. pot-shaped, protrude into the stream. At the ultrasonic transducers or housing parts projecting or recessing into the stream, detachments and/or turbulences can occur, which can lead to measurement errors depending on the  
30 streaming speed.

EP 2 696 174 A1 discloses a flow meter with two ultrasonic sensors which are attached at a measuring channel, wherein the measuring signals are coupled into or out of the fluid via a respective coupling element which is inserted flush in the  
35 circumferential wall of the measuring channel.

In view of this, the invention is based on the object of creating a flow meter/flow counter with improved measuring accuracy.

5 This object is solved by a flow meter with the features of patent claim 1.

Advantageous further developments of the invention are the subject matter of the dependent claims.

10 According to the invention, the flow meter has a measuring channel which can be attached to a pipe through which a fluid flows and on which a measuring unit is held which has at least two measuring sensors, preferably ultrasonic transducers, which are spaced apart from each other. The coupling and decoupling of the measuring signals into and out of the fluid takes place via a common measuring bar or a respective  
15 coupling element, which accommodates the measuring sensor(s).

According to the invention, the measuring bar or the coupling element is inserted flush into a circumferential wall of the measuring channel. This means that neither the measuring bar or the coupling element nor the actual measuring sensor or any other  
20 housing part protrudes into the measuring channel, so that the measuring accuracy is significantly improved compared to conventional solutions due to the even streaming.

The coupling in of the signals is optimal, since the measuring bar or the coupling element has a coupling wedge which is inclined with respect to the measuring channel  
25 axis, on which at least one ultrasonic transducer rests..

According to the invention, the measuring bar or the coupling element or several coupling elements are attached to a measuring housing which accommodates the control electronics, further sensors, a battery pack, communication modules and/or a  
30 power supply. The battery pack can preferably be designed to be replaceable.

The construction of the flow meter is simplified because a pipe section that accommodates the measuring channel has a flange that encompasses at least one recess and to which a system adapter of the measuring housing that supports the  
35 measuring channel is attached.

In a preferred embodiment, a cross-section profile of the measuring channel is designed such that it has a larger clear width in the emitter / receiver direction of the sensors than transverse to them. The entire cross-section is preferably designed to be slightly smaller than the inlet and outlet cross-section of the flow meter, so that the fluid stream is accelerated in the area of the measuring channel. By increasing the dimensions in the emitter and receiver direction, the signal path and thus the runtime of the signal are also increased compared to a round cross-section.

In a particularly preferred embodiment, the measuring channel is approximately oval in shape, i.e. the measuring channel is not limited by straight walls in the direction of its high axis, but by slightly concavely curved side walls – this contributes to further even out the fluid stream.

In a particularly preferred embodiment, the side walls running in the direction of the high axis (approximately in emitter and receiver direction of the ultrasonic signals) are curved and form the aforementioned oval shape with approximately flat or slightly curved transverse walls running approximately in the direction of the transverse axis. Surprisingly, it turned out that such an oval geometry guarantees optimal streaming and an accompanying maximum signal quality.

In an alternative solution, instead of the oval shape, a roughly trapezoidal cross-section can be formed, wherein a transverse wall comparatively wide in the transverse direction is formed on the sensor side and a transverse wall with a significantly smaller width or a rounding is formed on the reflector side.

Sealing is particularly simple if this coupling element is sealed by means of a seal in the measuring channel.

Advantageously, the ratio of the width of the measuring channel in the vertex of the curvature of the side wall to the width of the transverse walls in the transverse direction can be  $> 1.2$ , preferably approx. 1.3 to 1.6. Alternatively or additionally, the ratio of the height extension of the side wall to the width of the transverse wall can be  $> 1.5$ , preferably approx. 1.5 to 2.

The fluid stream can be further evened out if, for example for small nominal widths, the coupling element extends as far as into the side wall. Also in this area, the coupling element is flush with the side wall, so that there are no projecting components that interfere with streaming.

5

In one embodiment of invention, the measuring housing is designed with a bottom in which the measuring bar with the ultrasonic transducers are inserted directly or by means of a sensor accommodation.

10 According to a further development of the invention, a reflector device is arranged on the transverse wall remote from the ultrasonic transducers, which is preferably inserted flush into a pocket of the transverse wall.

15 By the flush insertion of the reflector/mirror and/or of the measuring bar or the coupling elements into the measuring channel, turbulences and streaming stalls are prevented in the area of these components as well as an associated dirt deposition and the resulting signal falsification.

20 The construction can be further simplified if the pipe section forms the measuring channel. This requires that the pipe section is constructed according to the above-defined specifications (oval shape). Alternatively, the measuring channel can also be inserted into the pipe section.

25 In another embodiment, the flow meter has a housing that has two inlet and outlet mounting flanges between which the pipe section and/or the measuring channel extends, the flow cross-section in the lead-in area or respectively the lead-out area of the mounting flanges being smaller than in the measuring channel. The cross-section surface of the measuring channel can be about 25 – 35 % smaller than the cross-section surface of the inlet or of the outlet.

30

The reduction from/to the circular cross-section at the entrance or exit is achieved, for example, by so-called control bodies – hereinafter referred to as lead-in/lead-out bodies – which cause the constriction from the circular pipe cross-section to the oval cross-section of the measuring channel.

35

Such a double sensor is preferably used for smaller nominal diameters in the range of DN40 - DN125. For larger nominal diameters, for example in the range DN150 - DN300, single sensors arranged in pairs are used, as the coupling pieces of a double sensor would have relatively large dimensions at such large distances.

5

The signal quality can be further improved if the measuring bar or the coupling element is made of PEEK, PSU or PEI or another suitable plastic material.

10 In a further preferred solution, a double sensor is accommodated in a coupling element, so that two approximately parallel signal paths are formed.

In order to further improve the measuring accuracy, a reference path can be formed in each coupling element, which is determined by the geometry of the coupling element and its material.

15

In such a measuring bar or coupling element, a temperature sensor or another sensor can be accommodated which, for example, detects heating of the fluid or the measuring bar or the coupling element during the measurement and can make a corresponding signal correction. Instead of the temperature sensor, a pressure sensor  
20 can also be used, for example, which has a thin membrane oriented in the direction of the fluid stream, from whose deflection the pressure can then be determined. Of course, other pressure sensors or sensors of a different type can also be integrated into the coupling element.

25 More than two ultrasonic sensors/transducers can also be integrated into the coupling element.

This measuring bar can also be formed with a reference path, which for example enables a zero drift correction.

30

The influence of air bubbles and sedimentations can be reduced by tilting or transverse positioning (transverse to the direction of gravity) of the profile cross-section – this solution can also be used as subject matter of an independent patent request.

Preferred embodiments of the invention are explained in more detail below using schematic drawings. These show:

5 Figure 1 shows a first embodiment of a flow meter designed with a measuring insert according to the invention;

Figures 2a, 2b show further partial drawings of a flow meter according to Figure 1;

10 Figure 3 shows views of a further embodiment of a flow meter according to the invention;

Figure 4 shows views of a third embodiment of a flow meter;

15 Figure 5 shows a embodiment of a flow meter, wherein a measuring channel is formed by a measuring insert;

Figure 6 shows a partial drawing of the measuring bar of the embodiment according to Figure 5;

20 Figure 7 shows two further embodiments of a flow meter;

Figure 8 shows views of a housing of the flow meter according to Figure 7;

25 Figure 9 shows a further drawing of the embodiment according to Figure 7a);

Figure 10 shows an exploded view of a measuring insert of the embodiment according to Figure 9, 7a);

30 Figure 11 shows a further view of the measuring insert according to Figure 10 with a detail drawing of the measuring bar according to Figure 6;

Figure 12 shows views of a battery pack of a flow meter according to the invention;

35 Figure 13 shows an exploded view of the battery pack according to Figure 12;

Figure 14 shows a schematic diagram of a further embodiment of a flow meter with measurement attachment;

5 Figures 15a), b) and c) show views of a further embodiment of a flow meter with a measurement attachment;

Figure 15d) shows a variation of the embodiment according to Figures 15a), b), c);

10 Figures 16a), b), c) shows main component groups of a further embodiment of a flow meter with a measurement attachment;

Figures 17a), b), c) shows variations of the embodiment according to Figure 16 with external modules;

15 Figures 18 und 19 show variations of a housing of a flow meter according to Figures 16, 17;

Figure 20 shows a schematic diagram for explaining the structure of an ultrasonic transducer;

20 Figure 21 shows an embodiment of a measuring insert for a housing according to Figure 19;

25 Figure 22 shows drawings of a measurement attachment for a housing according to Figure 18;

Figure 23 shows a variation of the embodiment of a measurement attachment according to Figure 22;

30 Figure 24 shows a schematic diagram on the structure of a double sensor;

Figure 25 shows schematic diagrams for explaining the course of the signal paths of a double sensor;

Figure 26 shows an embodiment of a flow meter with an additional sensor, e.g. a pressure sensor;

Figure 27 shows drawings of a flow meter with an external sensor module;

5

Figure 28 shows a variation of a double sensor with an additional sensor, e.g. a temperature sensor;

Figure 29 shows drawings of three embodiments for reference paths for zero drift correction integrated into a coupling element;

10

Figure 30 shows drawings of a further embodiment of a flow meter with double sensors;

Figure 31 shows drawings a flow meter in which four single sensors are used instead of the double sensors, and

15

Figure 32 shows a comparison illustration of the flow meters of Figures 30, 31.

Figure 1 shows a first embodiment of a flow meter 1 executed with a measuring insert 2. The flow meter 1 has a housing 4, which has two mounting flanges 5, 6, between which a pipe section 8 extends. This housing 4 is inserted into an installed pipe through which the medium/fluid flows whose flow is to be measured.

20

The pipe section 8 has an approximately tangentially arranged flange 10, which encompasses a recess 12. The actual measuring insert 2 has a measuring channel 14, to which a sensor system as described below is assigned.

25

The control electronics and power supply and other components of the flow meter 1 required for signal processing are accommodated in a measuring housing 16. Furthermore, a display for the measured flow which is not visible in Figure 1 is provided on this housing. The measuring channel 14 is inserted through the recess 12 of the housing 4 into the cross-section of the pipe section 8 and the measuring housing 16 is then fixed at the flange 10.

30

35

Figure 2a) shows an exploded view of a part of the measuring insert of the flow meter according to Figure 1, and Figure 2b) shows the flow meter in the mounted state.

5 In the drawing according to Figure 2a), the housing 4 is shown with the pipe section 8, which lies between the two mounting flanges 5, 6. Tangentially to the pipe section 8 (in Figure 2a) pointing upwards) the flange 10 is formed, which encompasses the recess 12, through which the measuring insert 2, in particular the measuring channel 14, can be inserted into an interior space 20 of the pipe section 8.

10 For stream guidance in the inlet and outlet area, a lead-in and a lead-out body 22, 24 are inserted in the pipe section 8 or respectively in the mounting flange on the inlet and outlet side, wherein in the assembled state, these bodies establish a substantially fluid-tight connection to the measuring channel 14.

15 As explained in more detail below, this measuring channel 14 does not have a circular or rectangular cross-section, but is designed in an oval shape to reduce streaming stalls and turbulences. In the embodiment shown, the measuring channel 14 is attached to a system adapter 26 of the measuring insert 2 or the measuring housing 16. This system adapter 26 is also provided with two ultrasonic transducers –  
20 hereinafter referred to as sensors 28, 30 – which are arranged on coupling elements 32, 34, via which the ultrasonic signals are coupled into or out of the fluid.

Figure 2a) at the top shows a housing bottom 36 of the measuring housing 16 mounted on the system adapter 26.

25 Figures 3a) and 3b) show the measuring channel 14, which in turn is attached to the system adapter 26. As indicated in Figure 3a), the measuring channel 14 is surrounded in the connection area to the system adapter 26 by a circumferential sealing ring 38, which rests on the flange 10 in the mounted state. The system adapter 26 in  
30 turn is covered by the housing bottom 36.

This drawing shows that the measuring channel 14 made of plastic, for example, does not have a circular but an oval flow cross-section with a high axis  $h$  and a transverse axis  $q$ . The high axis  $h$  is longer than the transverse axis  $q$ . In the  
35 embodiment shown, the ratio of the dimensions is  $h : q > 1.2$ , preferably about 1.5. The

ratio of the length of the high axis  $h$  to the width  $b$  shown in Figure 3a) is  $(a : b) > 1.5$ , preferably about 2.

The width  $b$  indicates the width of transverse walls 40, 42, which are designed as flat surfaces or slightly concavely curved walls. In the direction of the high axis  $h$ , side walls 44, 46 extend, which together with the transverse walls 40, 42 define an approximately oval cross-section of the measuring channel 14. This ovalized, rounded cross-section form reduces streaming stalls and turbulences as compared to the conventional right-angled or circular channel cross-sections, whereby the signal propagation and the signal path are increased by the large height extension  $h$  and the streaming speed can be significantly increased as compared to the inlet area and outlet area by the comparatively small width  $q$ ,  $b$  in the transverse direction. It is a prerequisite that the lead-in body 22 and the lead-out body 24 have a cross-section that is smaller than the cross-section of the measuring channel through which the current flows, so that a corresponding increase in velocity occurs.

Figure 3c) shows the arrangement according to Figure 3a) in a three-dimensional representation in a slightly different view. As mentioned, the measuring channel 14 with the oval measuring channel cross-section is made of plastic and is surrounded by the sealing ring 38 attached to the system adapter 26. In the system adapter 26, the two coupling elements 32, 34 are arranged, of which only the coupling element 32 is visible in the drawing according to Figure 3c). In this drawing, it can be seen that the coupling element 32 is inserted flush into the flat or slightly curved transverse wall 42 on the sensor side, so that the measuring channel 14, or more precisely its circumferential wall, is largely smooth with rounded transitions.

Figure 3d) shows a plan view of the arrangement according to Figure 3c), wherein the lead-in body 22 and the lead-out body 24 are attached to the measuring channel 14. According to this drawing, the two coupling elements 32, 34 protrude slightly upwards beyond the large surface of the system adapter 26 visible in Figure 3 towards the housing floor 36 which is not shown. As will be described in more detail below, each coupling element 32, 34 has a coupling wedge 48, 50 to which – as will be explained in more detail below – the sensor is attached. The wedge angle of the coupling wedge 48, 50 is selected such that the ultrasonic signals generated by the sensor 28, 30 are coupled obliquely into the measuring channel 14.

As shown in Figures 3a), 3b), the measuring channel 14 or the stream cross-section provided in it can be aligned in such a way that its high axis  $h$  is set obliquely to the direction of gravity. In this way, an interference of the measuring signals due to sedimentations, air bubbles or the like is prevented. This inclination is possible in all embodiments described. As mentioned at the beginning, a horizontal arrangement is also possible, whereby the high axis of the oval profile is then arranged transversely to the direction of gravity.

Figure 4 shows a variation in which the flow meter 1 is executed according to the "measurement attachment" concept. The two coupling elements 32, 34 are inserted directly into the transverse wall 42. The measuring channel 14 in turn flows via the lead-in and lead-out bodies 22, 24 into the two external mounting flanges 5, 6. In this embodiment, the measuring channel 14 is thus formed directly by the pipe section 8, whereas in the embodiment according to Figures 1 to 3, the measuring channel 14 is inserted into the pipe section 8. The ovalized cross-section of the measuring channel 14 is also provided for the embodiment shown in Figure 4, whose high axis is set obliquely to the direction of gravity for the embodiment shown – this is particularly clearly shown in Figures 4b), 4c) and 4d). According to Figure 4a), the two coupling elements 32, 34 are – as explained above – inserted into corresponding recesses of pipe sections 8 and each have a coupling wedge 48, 50 on which the respective sensor 28, 30 is supported. These sensors can, for example, be formed by a piezoceramic, which is contacted via electrodes with the control accommodated in the measuring housing 16.

The angle of inclination of the coupling wedge 48, 50 is formed in such a way that the signals coupled into or respectively out of the measuring channel 14 by the two sensors are inclined approximately V-shaped to each other. The signal guidance is not limited to such a V-shape. For example, the signal path can also be W-shaped, whereby the measurement signal is then redirected from a first, opposite reflector back to another reflector, which is arranged between the two sensors. The signal is then directed from this reflector in the direction of a third reflector, which in turn is arranged on the opposite side and via which the measurement signal is reflected to the other sensor. The latter reflector is arranged in the same way as the first reflector. The central reflector on the sensor side can then be located at the measuring channel or at the

measurement attachment / measuring insert. Sealing of the coupling elements 32, 34 in the measuring channel 14 is carried out via sealing rings which are not shown.

5 In the drawing according to Figure 4b), it is again clearly visible that the fluid-side coupling surfaces of the two coupling elements 32, 34 are inserted flush into the corresponding transverse wall 42, so that the measuring channel 14 is surrounded by smooth circumferential walls.

10 Figure 4c) shows the measuring channel in a view from above, so that the transverse wall 40 opposite the coupling elements 32, 34 is visible. In this plane or slightly rounded transverse wall 40, a reflector 52 is inserted which lies at the vertex of the V formed by the two sensor axes. The signal path extends, for example, from a sensor 28 via the coupling element 48 into the cross-section of the measuring channel 14 towards the reflector 52. The measurement signal is then reflected from reflector 52  
15 to the other sensor 30, whereby the reflected signal is guided via the associated coupling element 34 and coupling the wedge 50 to sensor 30.

Figure 5 shows a variation of a version with "measuring insert". This drawing (see Fig. a)) shows the housing 4 described above with the two mounting flanges 5, 6,  
20 between which the pipe section 8 with the flange 10 extends. The measuring channel 14 shown in Fig. 5d) is inserted into the recess 12 of the housing 4 surrounded by the flange 10. This channel, in turn, has a pocket-shaped accommodation 56 in which a measuring bar 54 (Fig. 5b) is inserted. This one-piece measuring bar 54 replaces the aforementioned structure with two coupling elements and the associated sensors. As  
25 shown in Figures 5d) and 5b) in particular, the measuring channel 14 has a console 57 encompassing the accommodation 56 with which it is attached to the system adapter 26.

In the embodiment shown in Figure 5e), the system adapter 26 has a control  
30 housing frame 58, which forms part of the measuring housing 16 and in which an electronic module 60 shown in Figure 5c) is inserted, which contains all electronic components for power supply and signal processing. This electronic module 60 is connected to the sensors 28, 30 via a connector 62 arranged on the measuring bar 54.

Figure 5f) shows the lead-in body 22, which is attached to the measuring channel 14 in a substantially fluid-tight manner. The lead-out body 24 has a corresponding structure. As can be seen from this drawing, the end section on the measuring-channel side of the lead-in body 22 is adapted to the oval profile of the measuring channel 14 with regard to the cross-section profile. As a result, streaming is already accelerated within the lead-in body 22, since the cross-section tapers from the circular input cross-section to the oval measurement cross-section.

Figures 6a), 6b) show detail drawings of the measuring bar 54 inserted into the accommodation 56. It is made of plastic, e.g. PSU, PEEK, PEI or another suitable material and is inserted fittingly into the accommodation 56 of the measuring channel or more precisely into the console 57. The two sensors 28, 30, which are designed as piezo elements/ piezoceramics, are attached to coupling wedges 48, 50, which are integrally formed on the measuring bar 54. As can be seen in particular from Figure 6b), the measuring bar 54 is pot-shaped. In the space surrounded by the measuring bar 54, a printed circuit board 64 is arranged, which is connected to the connector 62 on the one hand and to the two sensors 28, 30 on the other hand for power supply and signal transmission. As can be seen in the drawing according to Figure 6a), connector 62 is sealed by a seal 66 in the control housing. The space surrounded by the measuring bar 54 is then filled with a casting compound 68, so that the sensors 28, 30, the printed circuit board 64, the corresponding contacts, etc. are embedded and fixed in a fluid-tight manner.

As shown in Figure 6b), a reference path 70 is formed in the measuring bar 54 between the two coupling wedges 48, 50 inclined towards each other. The signal emitted by one sensor 28 can in principle move along two signal paths to the respective other sensor 30. One signal path runs along the reference path 70 shown in Figure 6b) through the measuring bar 54 directly to the adjacent sensor 30. The other signal path 72 runs along a comparatively short path in the measuring bar 54 and is then coupled into the medium via this path. This signal path 72 continues to the reflector 52 (not shown in Figure 6) and from there towards the other sensor 30, wherein the signal from the fluid is coupled into the measuring bar 54 and then hits the sensor 30 along a relatively short path through the measuring bar 54.

The reference path 70 provides the measuring electronics with a reference signal that is independent of the flow of the fluid and can therefore be used for zero drift correction.

5            Figures 7 to 11 explain further variations of the embodiment according to Figures 5, 6. Figure 7 shows two concrete embodiments of flow meters 1, which are executed according to the principle "measurement attachment". Figure 7a) shows a flow meter 1 with the housing 4, to which the measuring housing 16 with the control electronics, the counter and a digital display 74 shown in Figure 7a) is attached. Figure 7b) shows a  
10            variation in which communication modules 76 are additionally attached to the measuring housing 16, which can be used, for example, to establish a wireless signal transmission to a computer, a mobile readout station, a connection to sensors or the like.

              Figures 8a) to 8e) show the basic structure of the housing 4. Since the basic  
15            structure of the housing 4 largely corresponds to that of the housings described above, only a few design features are explained and for the rest reference is made to the above explanations on the housing structure.

              Figure 8a) shows a three-dimensional drawing of the housing 4 with the two  
20            mounting flanges 5, 6 and the pipe section 8 in between, on which the tangentially running flange 10 is arranged. This encompasses recess 12, into which the measuring insert, in the present case the measuring bar 54, is inserted in a fluid-tight manner.

              Figure 8b) shows a longitudinal section through the housing 4 according to Figure  
25            8a). It can be seen in this drawing that recess 12, which penetrates the flange 10, leads into the measuring channel 14 limited by the pipe section 8.

              Diametrically to recess 12, a pocket 78 is formed in measuring channel 14, into  
30            which the reflector 52 described above is fittingly inserted, preferably pressed. Figure 8c) shows a section along the line A-A in Figure 8b). In this drawing, the pocket 78, which leads into the transverse wall 40 of the measuring channel 14 below, is clearly visible. The recess 12 leads in a corresponding way into the transverse wall 42 at the top. The reflector 52, which is not shown, is inserted into pocket 78 through the recess 12 in this embodiment.

Usually, the housing 4 is powder coated. However, the powder coating is preferably not formed in the area of the pocket 78, so that the press fit can be produced with high accuracy. The Applicant reserves the right to base an independent claim on this press fit.

5

Figure 8d) shows a top view of the housing 4. This drawing clearly shows the pocket 78 which can be reached through the recess 12. Also clearly visible is the H-shaped sealing surface of the flange 10 with the fastening recesses, via which the measuring housing 16 is fastened to the flange 10.

10

Figure 8e) shows a side view of the measuring housing 4. A radially protruding projection 80 in which the pocket 78 is formed is clearly visible. This projection 80 is diametrically opposed to the flange 10.

15

Figure 9 shows a detail drawing of the measuring housing 16 of the embodiment shown in Figure 7a). Accordingly, the housing has the already described system adapter 26, which is formed in one piece with the control housing frame 58, which in turn accommodates the electronic module 60 and the digital display 74. The measuring housing 16 is closed off by a housing cover as seen by the viewer in Figure 9.

20

As explained above, the measuring bar 54 is mounted on system adapter 26 and designed to be flush with recess 12 of the housing 4 (see Figure 8).

Figure 10 again shows an exploded view of the measuring housing 16. As explained, this consists in principle of the system adapter 26 with the control housing frame 58. The electronic module 60 is inserted into the control housing frame 58 and with the measuring bar 54 contacted via connector 62. The electronic module 60 contains the digital display 74 described above, the counter and the other components required for signal processing and power supply. The digital display 74 is then covered by a transparent pane 84 and fixed to the control housing frame 58 via the housing cover 82.

30

The embodiment explained on the basis of Figures 9 and 10 has an exchangeable battery pack 86 which can be inserted into the measuring housing 16. For this purpose, the control housing frame 58 is formed with a battery supply opening 88, through which

35

the battery pack 86 can be inserted into a holder 90 of the electronic module 60. This holder 90 then has corresponding contacts so that the electronic components are supplied with power via the battery pack 86.

5           Figure 11 shows a view from below of the measuring housing 16 according to Figure 9. In this drawing, the battery pack 86 is inserted into the control housing frame 58 and thus also into the electronic module 60. The measuring bar 54 protrudes downwards from the system adapter 26.

10           Figure 12 shows again two detailed views of the battery pack 86, which has a lid 92 with two shells 94, 96 shown in Figure 13, forming an enclosing housing for the actual battery block 98. The contacts 100 for contacting the electronic module 60 protrude from the front face of the housing remote from the lid 92.

15           Figure 14 shows a variation of the embodiments described above in which the measuring channel 14 formed by the pipe section 8 is not oval but trapezoidal in the broadest sense. The measuring channel 14 has – similar to the embodiments described above – two side walls 44, 46, which extend between a sensor-side transverse wall 42 and a lower transverse wall 40. The two side walls 44, 46 are arranged approximately  
20 V-shaped to each other, so that the width B of the transverse wall 42 is clearly larger than the width b of the transverse wall 40. Due to this approximately trapezoidal geometry, a cross-sectional narrowing occurs in turn in the direction of the transverse transverse axis, while in the direction of the upright high axis a signal path is created that is larger than a circular cross-section.

25           As shown in Figure 14, the reflector 52 is inserted in the area of the narrower transverse wall 40 lying below. The wider transverse wall 42 at the top is designed with flange 10, to which a measurement attachment 2 with two single or double sensors 28, 30 can be attached. The basic structure of each of the measurement attachments or  
30 measuring inserts described can be used.

In Figures 15a) to 15d) further embodiments of flow meters 1 are shown. Figures 15a), 15b) and 15c) show different views of a flow meter 1 in which the sensor system is designed as a measurement attachment. As with the embodiments described above, a  
35 measurement attachment 2 with a measuring housing 16 is attached to the housing 4

with the two mounting flanges 5, 6, with one or more communication modules for signal transmission attached to it.

Figure 15d) shows a variation with a digital display 74.

5

The embodiments shown in Figure 15 are in principle made up of two main components, the measuring housing 16 shown in Figure 16a) and the housing 4 shown in Figure 16b). The measuring housing 16 is designed as a measurement attachment and is attached to the flange 10 of the housing 4. This assembly process is shown schematically in Figure 16c). This drawing shows the two sensors 28, 30, which are inserted in the openings/recesses of flange 10 explained in more detail below.

10

Depending on the case of application, other modules can be attached to the measuring housing 16 – as explained above – for example the L-shaped communication modules 76 explained above (see Figure 17a)). This attaching is shown in Figure 17b). In the embodiment shown, the measuring housing 16 is designed with a swivelling cover 102, which can be opened to insert the communication modules 76 or other modules, so that they can be inserted into corresponding slots and contacted with the electronic module 60. After this insertion, the cover 102 is closed (see Figure 17c)) so that the communication modules 76 or other modules/components are fixed in position and contacted if necessary.

15

20

On the basis of Figures 18 and 19, two basic possibilities of the design of the housing 4 are explained.

25

Both housing variations do not differ in the geometry of the measuring channel 14, which is again designed as an oval profile. This oval profile is shown in the common side view (c)) with the two variations (Figures 18, 19).

30

In the embodiment of the housing 4 shown in Figure 18, the flange 10 is designed with a single recess 12 into which the measuring insert with the sensor system is inserted. As shown in Figure 18a), the reflector 52 is mounted through the recess 12, whereby the reflector 52 is then inserted – similar to the embodiment in Figure 8 – into a pocket 78 of the pipe section 8. This pocket 78 can again be formed in a projection 80.

35

Figure 19 shows a variation in which not a single recess but a separate recess 12a, 12b is provided for each sensor 28, 30, into each of which a sensor 28, 30 is inserted, the basic structure of which is explained using Figure 20. With these relatively small recesses 12a, 12b, it is difficult to mount the reflector 52 through these recesses. For this reason, it is preferred with such an embodiment to design the projection 80 with the pocket 78 open towards the outside, so that the reflector 52 can be inserted into the pocket 78 from the outside. Sealing is then carried out using a sealing cap 104.

As with the embodiments described above, the measuring signals are coupled in and out via an upper, preferably flat or slightly curved transverse wall 42, with the sensors inserted flush into the wall. The reflector 52 is inserted in a corresponding manner into the opposite transverse wall 40, which is spaced from the sensors.

Figure 20 shows the basic structure of the sensors 18, 20 as it can be used with the embodiments described above. Each sensor 18, 20 is held in a coupling element 32, 34. As previously explained using the measuring bar 54, each coupling element 32 has a coupling wedge 48 with the respective sensor 18 at its inclined wedge surface.

Like the measuring bar 54, the coupling element 32 and the coupling wedge 48 are made of a suitable plastic such as PEEK, PSU or PEI. Of course, other materials can also be used which fulfil the following criteria: the material should enable signal transmission with a stable sound velocity in the range from 2000 to 2400 m/s, the temperature influence should be as small as possible or at least linear, the material should have a low coefficient of linear expansion, the material should have sufficiently good adhesive and casting properties and should also have low water absorption or only a slight change in the relevant properties due to water absorption. In addition, the material should be suitable for use in drinking water environments and be comparatively inexpensive.

In the embodiment shown, the coupling element 32 is approximately pot-shaped, whereby an accommodation chamber 106 is filled with a casting compound or the like. A ring flange 108 is provided on the outer circumference of the coupling element 32, which in the assembled state stretches over an O-ring 110, so that the coupling element 32 can be inserted in a sealing manner into an accommodation in the housing 4 or in the measuring housing 16. The acoustic and mechanical coupling of the sensor 18 to

the coupling wedge 48 is carried out via a grease, gel, silicone pad and/or adhesive. This layer is marked in Figure 20 with the reference sign 112. The contact of the sensor, i.e. of the piezoceramic for example, is made via two electrodes 114a, 114b, whereby the lower electrode 114b, which is on the coupling wedge side, is led upwards on one side to the other electrode 114a, so that contacting is simplified from above.

On the basis of Figure 21, the structure of a measurement attachment 2 for a housing according to Figure 19 is explained. As described above, this embodiment of a housing 4 has two individual recesses 12a, 12b (see Fig. 21d)), into each of which a sensor 28, 30 with the associated coupling element 32, 34 is inserted in a sealing manner. As shown in Figure 21d), the two coupling elements 32, 34 with the sensors 28, 30 integrated therein but not shown as well as the two O-rings 110 are inserted individually into the respective recesses 12a, 12b and sealed there by means of the O-rings 110. The measuring housing 16 is then placed onto the flange 10, whereby the sealing ring 38 is arranged between the system adapter 26 of the measuring housing 16 and the flange 10 and encompasses the two sensors 28, 30 with the coupling elements 32, 34, so that the electronic module 60 is also sealed towards the fluid. As shown, for example, in Figure 20b), the coupling element 32 ends in a flush manner with the transverse wall 42 of the measuring channel 14. In the embodiment explained in Figure 21, this transverse wall is basically formed by the flange 10 of the housing 4. For small nominal widths, it can happen that the coupling element 32, 34 has a slightly larger diameter than the width of the transverse wall 42, so that the edge areas of the coupling element 32, 34 extend as far as into the side walls 44, 46. In such a geometry it can be advantageous if – as in the embodiment according to Figure 21a), 21c), 21d) – the areas of a coupling surface 116 formed in the transition area to the side walls 44, 46 are formed with protrusions 118a 118b (see Figure 21c)) extending to the side walls 44, 46, whereby these protrusions 118a, 118b run flush into the side walls 44, 46, so that the coupling elements 32, 34 are fitted accurately, without overhang or dug-out in the circumferential walls of the measuring channel 14.

The position fixing of the coupling elements 32, 34 in the measuring housing 16 in the embodiment shown in Figures 21 is carried out via fixing elements 120 (see Figure 21c, 21a)), which on the one hand encompass the coupling elements 32 or 34 and on the other hand are attached to the system adapter 26. As explained above, in this

embodiment the reflector 52 is mounted from the outside, whereby it is inserted into the pocket 78 of the housing 4, which is open towards the outside.

5 A disadvantage of the direct fixation of the sensors 28, 30 and coupling elements 32, 34 in housing 4 is that the latter has a comparatively complex structure and therefore places relatively high demands on the production, especially the casting.

10 In the embodiment according to Figure 22, a housing according to Figure 18 is used, which is easy to produce and in which the sensor system is inserted into a single large recess 12 of the flange 10. In the embodiment shown in Figure 22, the measuring housing 16 has a plate-shaped sensor accommodation 121, e.g. made of plastic, which is connected to the system adapter 26 on the one hand and has two recesses 122a, 122b (see Figure 22d) on the other hand, into each of which a coupling element 32, 34 is inserted in a sealing manner. This sealing is performed using O-rings 110 again. As shown in Figure 22b) in particular, the coupling elements 32, 34 are flush with the surface of the sensor accommodation 121 on the measuring channel side when mounted. This surface thus forms part of the transverse wall 42 of the measuring channel 14 – for this reason, this surface is also given the reference sign 42 in Figure 22b). When mounted, the sensor accommodation 121 immerses into the recess 12 of the flange 10 and is sealed there by an additional ring-shaped seal 148 which rests on a shoulder 150 of the flange 10. Also in this embodiment, the coupling elements 32, 34 and also the sensor accommodation 121 are formed with projections 118 projecting towards the side walls 44, 46, which ensure a continuous transition to the respective adjacent side wall 44, 46. As mentioned above, these projections 118 are not required for larger nominal widths, as the coupling elements 32, 34 can then be inserted with their full surface into the transverse wall 42.

30 The sensor accommodation 121 and the system adapter are sealed with respect to the flange 10 by means of the circumferential sealing ring 38. Accordingly, four seals (two O-rings 110, the sealing ring 38 and the seal 148) are required for the solution according to Figure 22.

35 The technical effort can be further reduced if – as shown in Figure 23 – the two coupling elements 32, 34 are inserted into a sensor plate 124 of the measuring housing 16, which is either formed on the system adapter 26 or attached to it. This means that

the function of the sensor accommodation 121 explained in Figure 22 is integrated in the measuring housing 16.

The sensor plate 124 has according to the drawing in Figure 23d), accommodations 122a, 122b, in which the two coupling elements 32, 34 are inserted in a sealing manner. Sealing is achieved by means of the O-rings 110. The position of the coupling elements 32, 34 is then fixed by means of fixing elements 120, which hold the sensor system in the measuring housing 16.

In this embodiment, at least a part of the sensor-side transverse wall 42 is formed by the sensor plate 124. For small nominal widths, the two projections 118 can again be formed on the coupling element 32, 34 and aligned to it on the sensor plate 124 (see Figs. 23a), 23c)) so that a continuous transition to the adjacent side wall 44, 46 is ensured. The measuring housing 16 with the sensor plate 124 is then again sealed by means of the circumferential sealing ring 38 (Figure 23c)) with respect to the housing 4. For this purpose, the sensor plate 124 is immersed in the recess 12 of the flange 10.

In the embodiment shown in Figure 21, only three seals (two O-rings 110 and the sealing ring 38) are required.

Due to the comparatively large recess 12, the reflector 52 of this embodiment can also be inserted through the recess 12 into the pocket 78 of the pipe section 8, whereby the reflector 52 is also inserted flush and aligned into the transverse wall 40 below.

In the embodiments described above, a single sensor 28, 30 is arranged in each coupling element 32, 34. Figure 24 shows an embodiment in which two sensors 28a, 28b; 30a, 30b are arranged in each of the two coupling elements 32, 34. These sensors 28, 30 are connected to coupling wedges 48, 50 of the respective coupling element 32, 34. The fixing in the measuring housing 16 is again achieved by means of fastening means, for example screws and/or fixing elements 120. As explained above, also more than two sensors 28, 30 can each be integrated into one coupling element. In the drawing according to Figure 24, one of the two protrusions 118a can be seen, which enter flush into the side walls 44, 46. In the drawing according to Figure 24, also a circumferential ring groove 126 for the accommodation of an O-ring 110 is visible.

Such a double sensor has the advantage that two parallel signal paths can be formed, as shown in Figure 25 for example. At the top, an embodiment of a flow meter 1 with a comparatively small nominal diameter of DN50 is shown. The indicated measuring channel has, for example, an upper transverse wall 42 in which the two double sensors, i.e. the two coupling elements 32, 34 with the respective sensors 28a, 28b and 30a, 30b, are inserted flush. The coupling elements 32, 34 run with their coupling surfaces 116 flush to the transverse walls 42, whereby due to the small nominal width in the transition area to the side walls 44, 46, the coupling elements 32, 34 are each designed with the mentioned protrusions 118a, 118b, which run flush into the side walls 44, 46.

As explained at the beginning, such a double sensor is preferably used for lower nominal widths with a coupling element 32, 34 common to both sensors 28, 30. For larger nominal widths, two parallel single sensors are preferably used instead of a double sensor, so that four single sensors are held at the measurement attachment / measuring insert instead of two double sensors.

With such double sensors or single sensors arranged in pairs, the measurement takes place along two parallel signal paths 128a, 128b, which run for small nominal widths (see Figure 25a)) at a comparatively smaller distance than for large nominal widths (see Figure 25b)). With such large nominal widths, the sensor-side transverse wall 42 is so wide that this width is larger than the diameter of the coupling elements 32, 34, so that it is possible to dispense with the formation of the protrusions 118 and thus the coupling surface 116 is flat or is formed according to the slight curvature of the transverse surface 42.

Figure 26 shows a design variation in which, in addition to the two sensors 28, 30 with the associated coupling elements 32, 34, a further sensor is provided, for example a pressure sensor 130. The embodiment shown in Figure 26 has the basic structure of the embodiment according to Figure 23, in which the two sensors are integrated into the measuring housing. The two coupling elements 32, 34 according to Figure 26d) are inserted into the accommodations 122a, 122b of the sensor plate 124 on the measuring insert side. The pressure sensor 130 is located in the area between the two accommodations 122a, 122b or respectively the coupling elements 32, 34 inserted therein. Contact is established via contacts 132, which project through the sensor plate

124 and the system adapter 26 into the space surrounded by the control housing frame 58 and are contacted there with the electronic module 60 (see Figures 26b) and 26d)).

5 The drawing according to Figure 26c) clearly shows the flush embedding of the coupling elements 32, 34 into the measuring channel 14. On the left side, the two protrusions 118 are visible, which enter flush into the side walls 44, 46.

10 In the embodiment described above, the pressure sensor 130 is thus integrated into the control housing. Figure 27 shows an embodiment in which a pressure sensor module 134 is attached to the side of the pipe section 8, i.e. approximately in the middle of the side walls. Signal transmission and power supply are then carried out via a flexible line (power/signal transmission chain) 136, which is connected to the electronic module 60 or the battery pack 86 of the measuring housing 16. This connection of line 136 can be made in approximately the same way as it is provided for the  
15 communication modules (see Figure 17b)).

Figure 28 shows a variation of the double sensors according to Figure 24. The basic structure corresponds to that of Figure 24, so that explanations in this regard are unnecessary. In addition to the two double sensors, in the embodiment according to  
20 Figure 28, temperature sensors 138 are accommodated in the respective coupling elements 32, 34, by means of which the temperature of the sensors 28, 30 and/or of the coupling elements 32, 34 can be detected and corresponding signal corrections can be made in the event of a change in temperature. These temperature sensors 138 can, for example, be inserted into suitable recesses/pockets in the area of the coupling wedge  
25 of the 48.

Figure 29 illustrates again the possibilities for the formation of a reference path.

30 Figure 29a) shows the already described reference path 70 (P2) in measuring bar 54, which extends from one sensor 28 in a zigzag pattern to the other sensor 30. The actual signal path 72 (P1) exits the measuring bar 54 after a comparatively short distance, whereby this occurs via the coupling surface 116 which is flush with the measuring channel 14.

Figure 29b) shows a possibility to form such a reference path P2 also in a coupling element 32. In this case, for example, a mirror 140 is arranged in the coupling element 32 in parallel to the sensor 28, which is supported by the coupling wedge 48. The measuring signal is then reflected via this mirror 140 and redirected back to the sensor 28, which then receives the transmitted signal again and thus makes a correction possible. The measuring beam P1 enters the measuring channel in a manner known per se via the coupling surface 116.

In a double sensor according to Figure 29c), the coupling element 32 is designed in such a way that, for example, part of the signals transmitted by the sensor 28a are reflected in the coupling element 32 and deflected to the sensor 28b arranged in parallel, so that this sensor 28b receives the signal of the sensor 28a – a reference path P2 is again formed, which extends between the two sensors 28a, 28b. The majority of the signals are coupled into the measuring channel or the fluid flowing through it via the coupling element 32 and the coupling surface 116 in a manner known per se. The drawing according to Figure 29 again indicates the protrusions 118a, 118b which are advantageous for a small nominal width.

In the embodiments described above, the oval cross-section of the measuring channel 14 with its high axis is either arranged in the vertical direction (i.e. in the direction of gravity) or obliquely to it. In principle, this "high axis" can also be arranged horizontally, i.e. transversely to the vertical direction.

Figure 30 shows a flow meter 1 with a double sensor, as explained in Figures 24, 25, 28 and 29c).

As shown in Figure 30a), housing 4 is in principle designed like in the embodiments described above. Accordingly, the housing has a flange 10 formed on the pipe section 8, on which the two recesses 12a, 12b for the coupling elements 32, 34 (see Figure 30b)) are formed. In contrast to the embodiments described above, the end sections forming the coupling elements 32, 34 or respectively their coupling surface 116 and projecting into the recesses 12a, 12b are formed approximately rectangular with rounded "corner areas". Accordingly, the recesses 12a, 12b are also rectangular with rounded transitions between the shorter and the longer peripheral edges. As the drawing in Figure 30a) further shows, each recess 12a, 12b has a shoulder 142 on

which the respective O-ring 110 of the sensor 28, 30 rests in a sealing manner when mounted. In the embodiment shown, the two sensors 28, 30, designed as double sensors, are inserted into the system adapter 26. This system adapter 26, for example, is pot-shaped (see Figure 32) with corresponding accommodations 144 for the sensors 28, 30. After inserting these sensors 28, 30 into the accommodation 144 of the system adapter 26, the interior can be filled with a casting compound so that the sensors 28, 30 are reliably accommodated in a sealing manner. The system adapter 26 then carries the control housing frame 58 in the above-described manner, which accommodates the electronic module 60 and the like that is not shown.

10

In the embodiment shown in Figure 30, a system adapter 26 is thus assigned to both sensors 28, 30. In principle, it is also possible to accommodate both sensors 28, 30 in one system adapter each. The system adapter 26 is also called sensor plate. Such a solution with double sensors is – as mentioned at the beginning – especially used for flow meters 1 with a small nominal width.

15

For larger nominal widths, a solution as shown in Figure 31 is preferred. In such an execution according to Figure 31b), instead of the two double sensors, four single sensors 28a, 28b, 30a, 30b each with a coupling element 32a, 32b, 34a, 34b are used, to which four recesses 12a, 12b, 12c, 12d are accordingly assigned in the flange 10 of the housing 4. The basic structure of this solution with four single sensors corresponds to that of the embodiment according to Figure 30. However, the individual sensors 28a, 28b, 30a, 30b are not rectangular in shape but oval, i.e. with rounded vertex edges and somewhat longer longitudinal edges, which together form an approximately oval coupling surface 116. Accordingly, recesses 12a, 12b, 12c, 12d are also oval-shaped. The O-rings 110 also lie on shoulders 142 of the respective recesses 12a, 12b, 12c, 12d in this embodiment. Corresponding shoulders for the seals are in principle realized with all embodiments described above.

20

25

30

For sealing between the flange 10 and the system adapter, a sealing ring 38 is again provided which is not shown.

As in the embodiments described above, the single and double sensors shown are each inserted in coupling elements 32, 34, whereby the respective piezoceramics each rest on a coupling wedge 50 of the coupling element 30, 32. Since these elements are

35

already described in detail above, reference is made to this explanation to avoid repetitions in this regard.

As explained above, for the larger nominal widths, the distance between the adjacent single sensors 28a, 28b or 30a, 30b – as shown in Figure 25b) can be larger than for the embodiment according to Figure 30, so that the signal paths run at a larger parallel distance. In the embodiment shown, all four sensors 28a, 28b, 30a, 30b are again accommodated in a common system adapter 26 and preferably fixed in position by means of a casting compound 146.

In Figure 32, the two concepts are arranged side by side in a longitudinal section. Figure 32a) shows the longitudinal section of the embodiment according to Figure 30. In this drawing the two coupling elements 32, 34 can be seen, on whose wedge surfaces 48, 50, two sensors 28 or respectively 30 (only respectively one visible in Figure 32a)) are arranged. These are each inserted into recesses 12a, 12b and sealed there by means of the O-rings 110. The coupling surfaces 116 run flush to the peripheral wall (transverse wall 42 and adjacent areas of the side walls 44, 46) of the measuring channel 14, which in this embodiment is formed by the pipe section 8. Part of the flange 10 thus forms the transverse wall 42. The opposite transverse wall 40 of this embodiment is formed with the pocket 78 open towards the outside, into which the reflector 52 is pressed.

In this drawing the casting compound 146 can be seen with which the two coupling elements 32, 34 with the sensors 28, 30 are fixed in position in the pot-shaped system adapter 26.

Figure 32b) shows a corresponding section of the flow meter according to Figure 31. According to the relevant explanations, the two coupling elements 32, 34 of this embodiment executed with single sensors are considerably more compact than in the embodiment according to Figure 32a. Each of the coupling elements 32 is sealed in the respective recess 12a, 12b, 12c, 12d by means of an O-ring 110. All coupling surfaces are flush with the transverse wall 42.

In the drawing according to Figure 32b), the reflector 52 was not shown for the sake of simplicity. In principle, however, it is located at the same position as the aforementioned reflector 52. This is indicated by a dotted line.

5 In principle, the technical effort in terms of devices and assembly is greater for the embodiment according to Figure 32b) than for the embodiment described above, since, for example, four recesses 12a, 12b, 12c, 12d and four single sensors 28a, 28b, 30a, 30b/coupling elements 32a, 32b, 34a, 34b and corresponding O-rings 110 have to be provided, whereas for the embodiment according to Figure 31a) only two of these  
10 respective components are present.

In the embodiments described in Figures 30, 31, 32, the transverse wall 42 is formed by part of the flange 10. However, as explained above, instead of the individual recesses 12a, 12b, 12c, 12d, a comparatively large recess 12 can also be provided, into  
15 which a system adapter 26 or a sensor plate is then immersed, in which the coupling elements 32, 34 are then arranged flush, so that the system adapter forms a part of the measuring channel and the transverse wall 42 of the oval profile. Such an embodiment is explained, for example, in Figure 22 above. In this variation, the system adapter 26 has a sensor accommodation 121 (sensor plate 124) in which the sensors 28, 30 are  
20 inserted.

In a preferred solution, the system adapter 26 itself is designed as a sensor accommodation, whereby in contrast to the embodiments according to Figures 30, 31, 32, the coupling elements 32, 34 are inserted flush into the system adapter or the  
25 sensor accommodation 121/sensor plate 124 (these are then practically integrated into the system adapter 26).

The Applicant reserves the right to base independent claims on each of these concepts (arrangement of the sensors/coupling elements in the pipe section or flush in a  
30 sensor accommodation/a sensor plate or flush in the system adapter).

In the embodiments according to Figures 21, 22, 23, too, the single sensors or respectively their coupling elements 32, 24 can be fixed in position with the respective system adapter 26 or respectively the sensor plate 124/the sensor accommodation 121  
35 by means of the casting compound 146.

Disclosed is a flow meter with at least two ultrasonic sensors, spaced apart from each other, wherein the coupling of the measuring signals into and out of a fluid is performed via a measuring bar or a coupling element which is inserted flush into a

5 circumferential wall of a measuring channel.

List of reference signs:

	1	flow meter
	2	measuring insert / measurement attachment
5	4	housing
	5	mounting flange
	6	mounting flange
	8	pipe section
	10	flange
10	12	recess
	14	measuring channel
	16	measuring housing
	20	interior
	22	lead-in body
15	24	lead-out body
	26	system adapter
	28	sensor
	30	sensor
	32	coupling element
20	34	coupling element
	36	housing bottom
	38	seal ring
	40	transverse wall
	42	transverse wall
25	44	side wall
	46	side wall
	48	coupling wedge
	50	coupling wedge
	52	reflector
30	54	measuring bar
	56	accommodation
	57	console
	58	control housing frame
	60	electronic module
35	62	connector

	64	printed circuit board
	66	seal
	68	casting compound
	70	reference path
5	72	signal path
	74	digital display
	76	communication module
	78	pocket
	80	projection
10	82	housing cover
	84	pane
	86	battery pack
	88	battery supply opening
	90	holder
15	92	lid
	94	shell
	96	shell
	98	battery block
	100	contacts
20	102	cover
	104	sealing cap
	106	accommodation chamber
	108	ring flange
	110	O-ring
25	112	adhesive, grease, gel
	114	electrode
	116	coupling surface
	118	projection
	120	fixing element
30	121	sensor accommodation
	122	accommodation
	124	sensor plate
	126	ring groove
	128	signal path
35	130	pressure sensor

	132	contact
	134	pressure sensor module
	136	flexible line
	138	temperature sensor
5	140	mirror
	142	shoulder
	144	accommodation
	146	casting compound
	148	seal
10	150	shoulder for seal

## **Patentkrav**

5 1. Flowmåler med et rørstykke (8), en måleenhed og en målekanal (14), der kan fastgøres til en rørledning, som en fluid strømmer igennem, og som ind-  
sættes eller kan indsættes i flowmålerens rørstykke (8), hvor måleenheden holdes på målekanalen (14), hvor måleenheden har et målehus (16), en systemadapter (26) og en målestang (54) eller koblingsstykker (32, 34) samt mindst to sensorer (28, 30), fortrinsvis ultralydssensorer, der er placeret i afstand fra hinanden, hvor målestangen (54) eller koblingsstykkerne (32, 34) optager mindst én sensor (28, 30), og hvor ind- og udkoblingen af målesignalerne henholdsvis i eller ud af fluiden sker henholdsvis via målestangen (54) eller via koblingsstykkerne (32, 34), hvor koblingsstykkerne (32, 34) eller målestangen (54) er indsat i flugt med en omløbsvæg af målekanalen (14), og hvert koblingsstykke (32, 34) eller hver målestang (54) har en koblingskile (48, 50), der er indstillet skråt i forhold til en målekanalakse, og som mindst en sensor (28, 30) hviler på, hvor koblingsstykkerne (32, 34) eller målestangen (54) er fastgjort til målehuset (16) ved hjælp af systemadapteren (26), der bærer målekanalen (14), og hvor systemadapteren (26), der direkte eller indirekte understøtter sensorerne (28, 30), er udformet på en sådan måde, at den kan fastgøres til en flange (10) på det rørstykke (8), der modtager målekanalen (14), hvor flangen (10) er anbragt tangentielt ved rørstykket (8) og omslutter en udsparring (12) af rørstykket (8).

25 2. Flowmeter ifølge krav 1, hvor en tværsnitsprofil af målekanalen (14) har en større fri bredde i sende-/modtagerretningen af sensorerne (28, 30) end på tværs af denne.

30 3. Flowmeter ifølge krav 2, hvor målekanalen (14) har omtrent en oval form eller er tilspidset i et område over for sensorerne (28, 30).

- 5 **4.** Flowmeter ifølge krav 3, hvor i retning af en vertikal akse (h) forløbende sidevægge (44, 46) af målekanalen (14) er udbulede og danner den ovale form af målekanalen (14) med tværgående vægge (40, 42) af målekanalen (14), der strækker sig omtrent i retning af en tværgående akse og er omtrent flade eller let udbulede
- 5.** Flowmeter ifølge krav 4, hvor målestangen (54) eller koblingsstykkerne (32, 34) er indsat flugtende i en af de tværgående vægge (42) af målekanalen (14).
- 10 **6.** Flowmeter ifølge et af de foregående krav, hvor koblingsstykket (32, 34) er forsegleet i målekanalen (14) ved hjælp af en tætning (38).
- 7.** Flowmeter ifølge et af de foregående krav, hvor forholdet mellem bredden (q) af målekanalen (14) i spidsen af udbulingerne og bredden (b) af de tværgående vægge (40, 42) af målekanalen (14) er større end 1,2, fortrinsvis omkring 1,3 til 1,6, og hvor forholdet mellem højdeforlængelsen (h) af sidevæggen (44, 46) og bredden (b) af den tværgående væg (40, 42) af målekanalen (14) er større end 1,5, fortrinsvis omkring 1,5 til 2.
- 15
- 20 **8.** Flowmeter ifølge et af de foregående krav, hvor hvert koblingsstykke (32, 34) strækker sig ind i sidevæggen (44, 46) af målekanalen (14).
- 9.** Flowmeter ifølge et af de foregående krav, hvor der i målekanalens (14) tværgående væg (40) fjernt fra sensorerne (28, 30) er anbragt en reflektor (52), som er indsat flugtende i en lomme (78) af den tværgående væg.
- 25
- 10.** Flowmeter ifølge et af de foregående krav, med et hus (4), som har to fastgørelsesflanger (5, 6), hvorimellem rørstykket (8) strækker sig, hvor strømningstværsnittet i indløbs- eller udløbsområdet af fastgørelsesflangerne (5, 6) er større end i målekanalen (14).
- 30

**11.** Flowmåler ifølge et af de foregående krav, hvor målestangen (54) og/eller koblingsstykket (32, 34) er fremstillet af PEEK, PSU eller PEI eller et andet passende plastmateriale.

5        **12.** Flowmeter ifølge et af de foregående krav og ifølge alternativet af krav 1, der er rettet mod koblingsstykkerne (32, 34), hvor der i det ene koblingsstykke (32, 34) er optaget mindst to sensorer (28, 30).

10       **13.** Flowmåler ifølge et af de foregående krav, hvor der inden i en målestang (54) er udformet en referencebane (70).

15       **14.** Flowmåler ifølge et af de foregående krav, hvor en temperatursensor (138), en tryksensor (130) eller en anden sensor er anbragt i målestangen (54) eller ved et målehus (16).

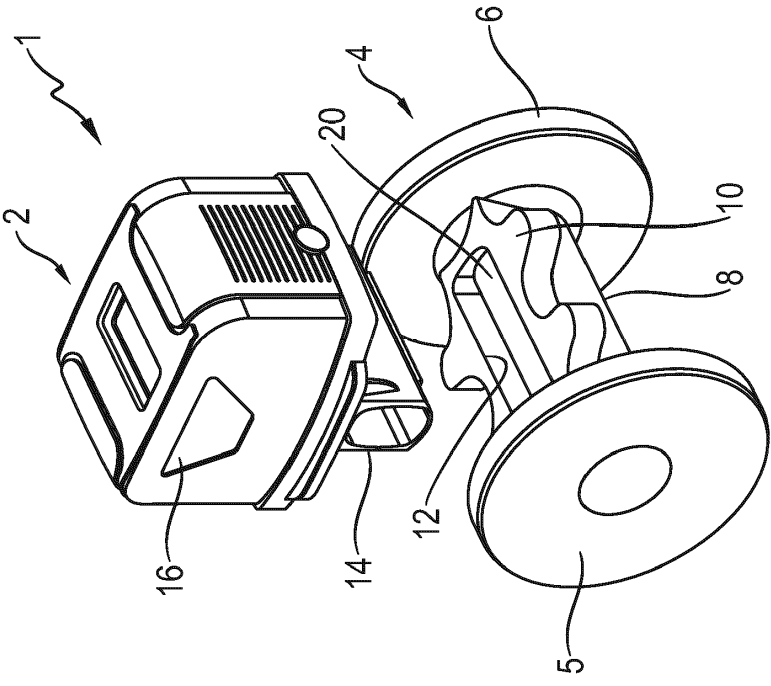


Fig. 1

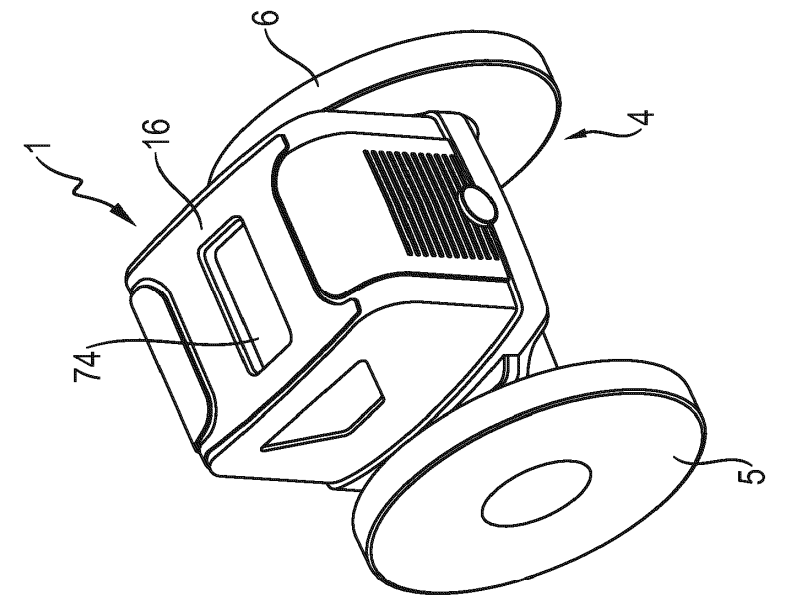


Fig. 2a

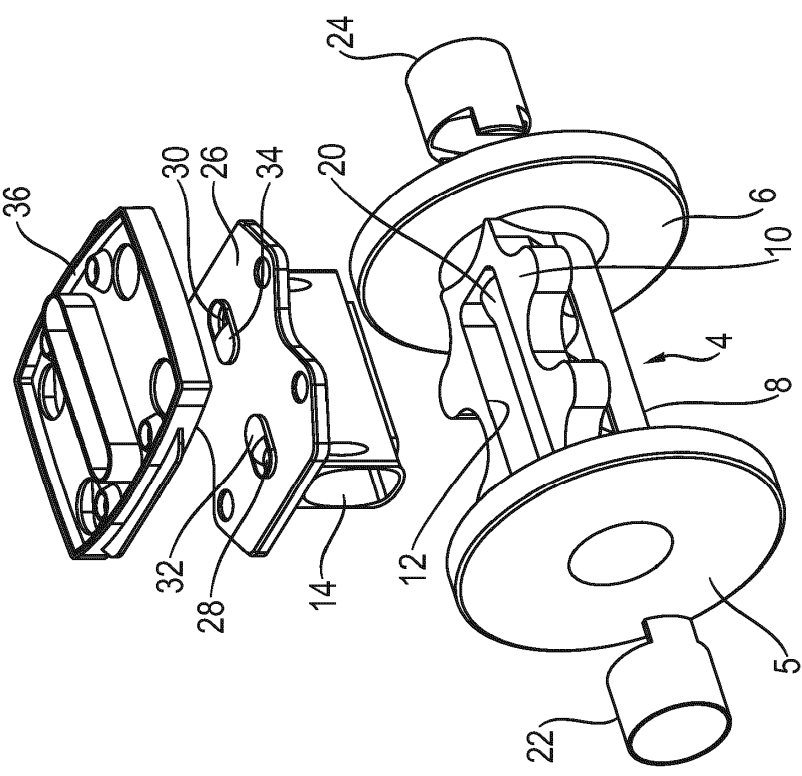
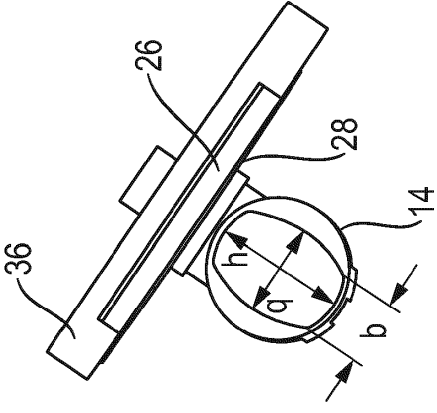
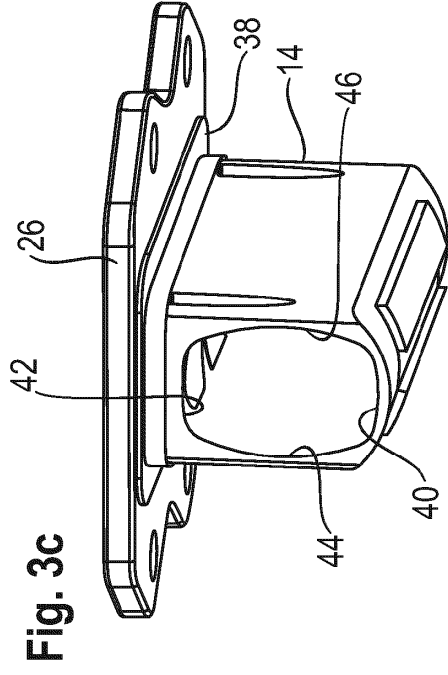


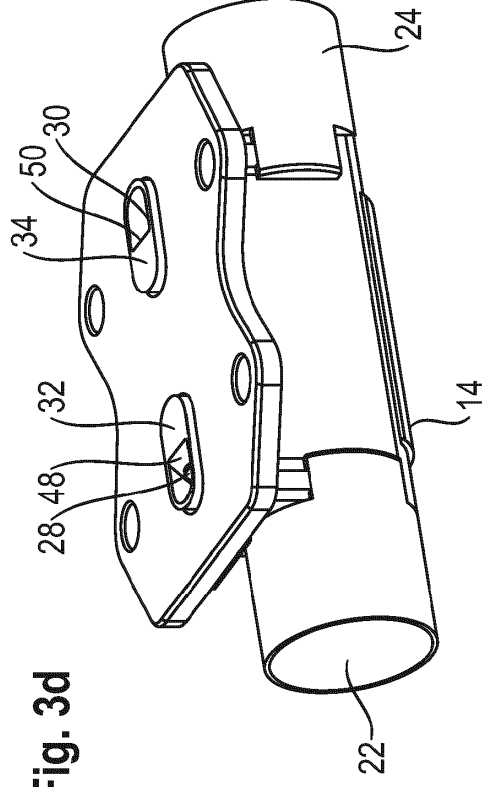
Fig. 2b



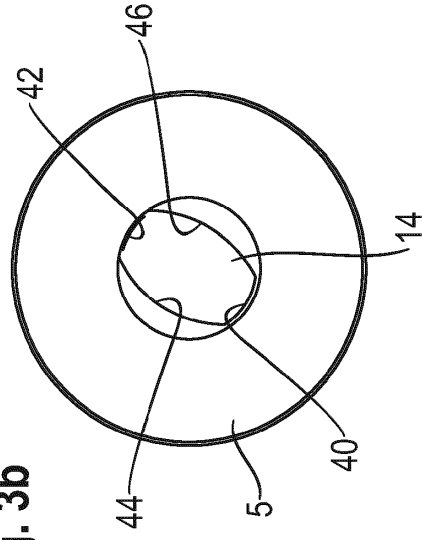
**Fig. 3a**



**Fig. 3c**

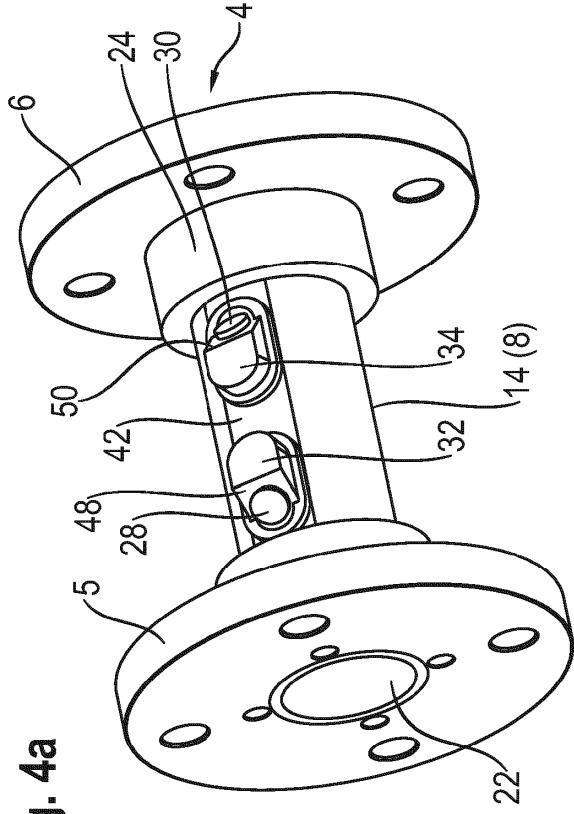


**Fig. 3d**

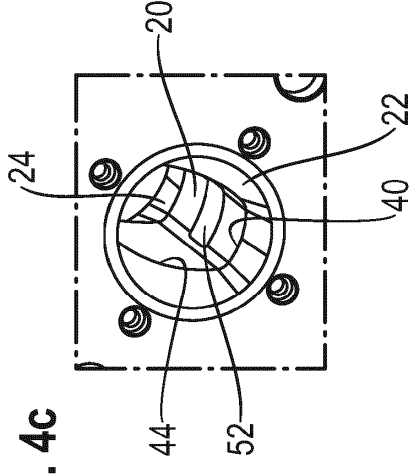


**Fig. 3b**

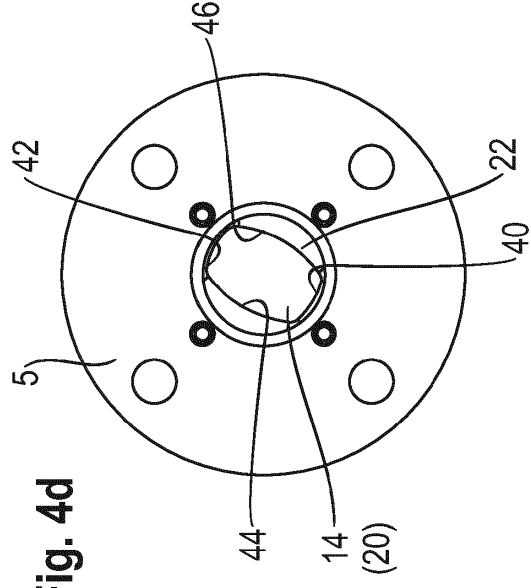
**Fig. 4a**



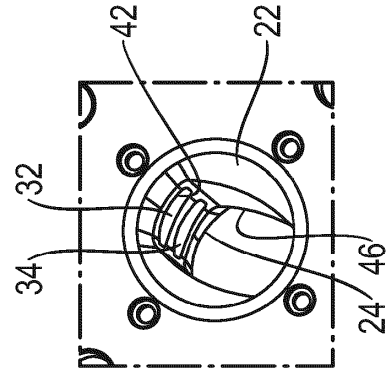
**Fig. 4c**



**Fig. 4d**



**Fig. 4b**



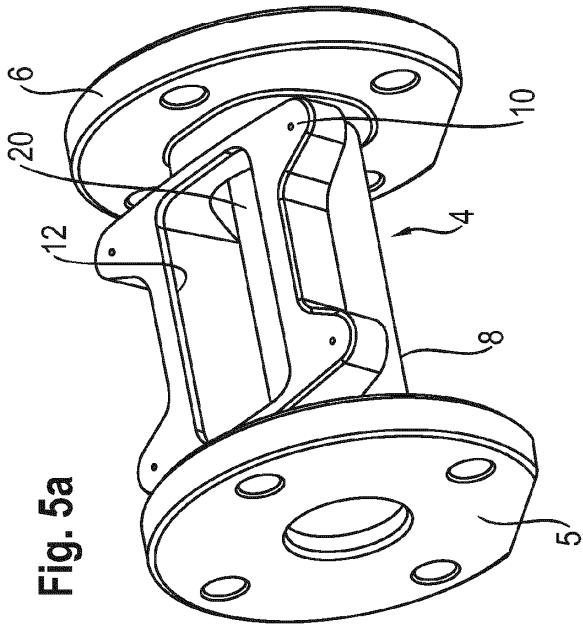


Fig. 5a

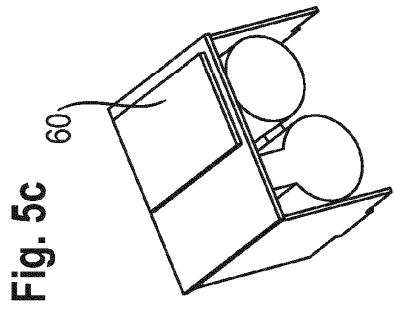


Fig. 5c

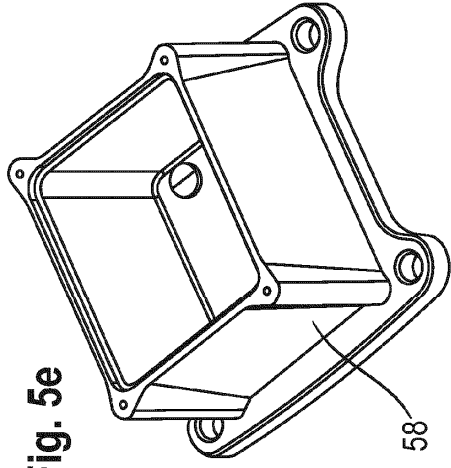


Fig. 5e

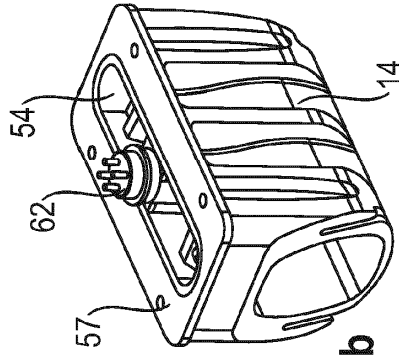


Fig. 5b

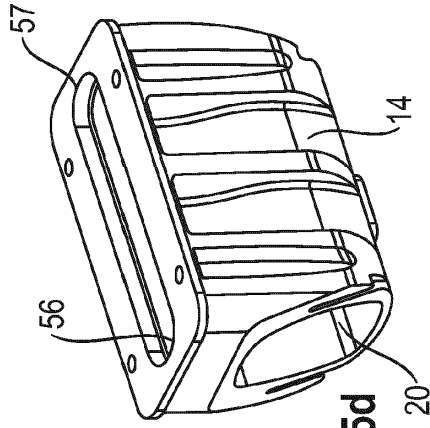


Fig. 5d

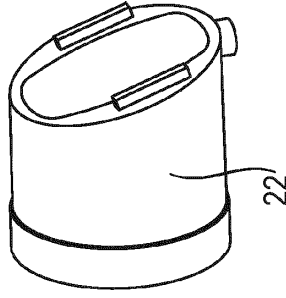
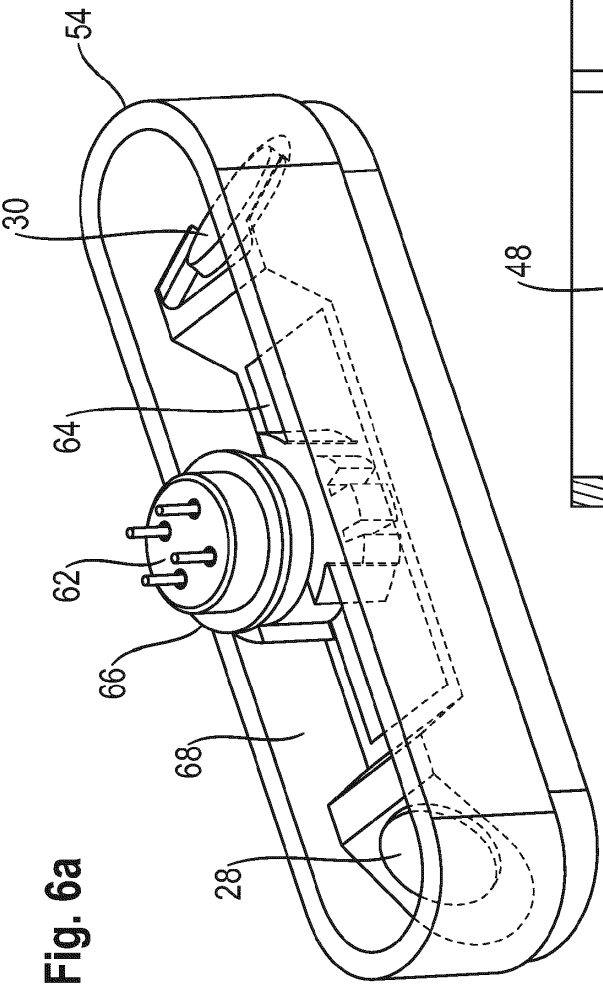
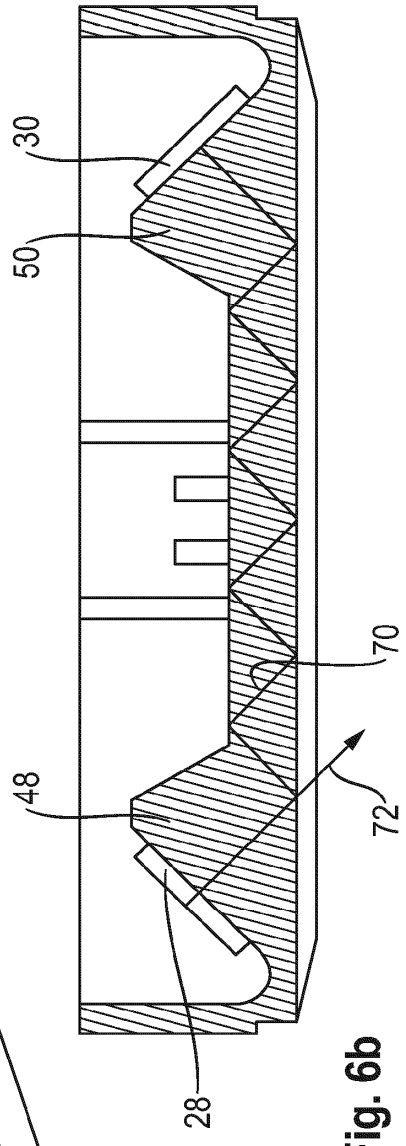


Fig. 5f

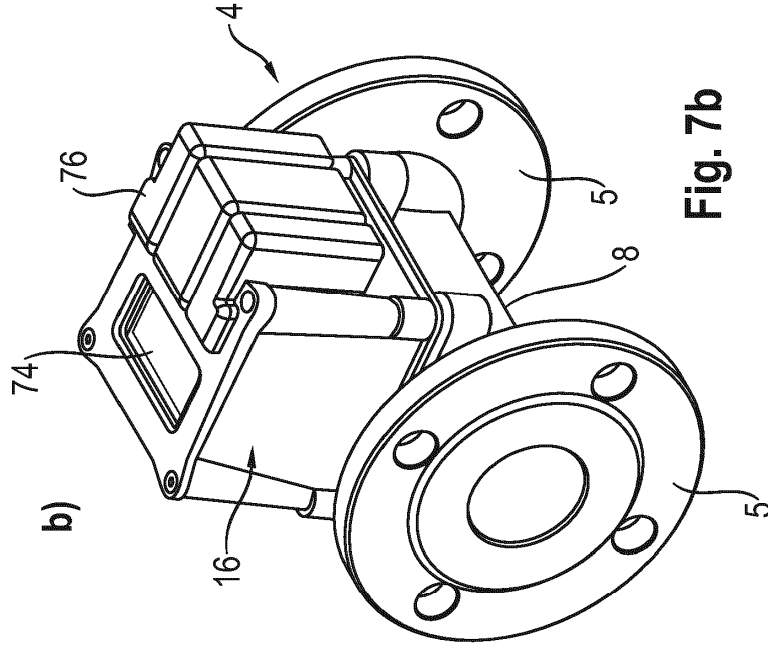
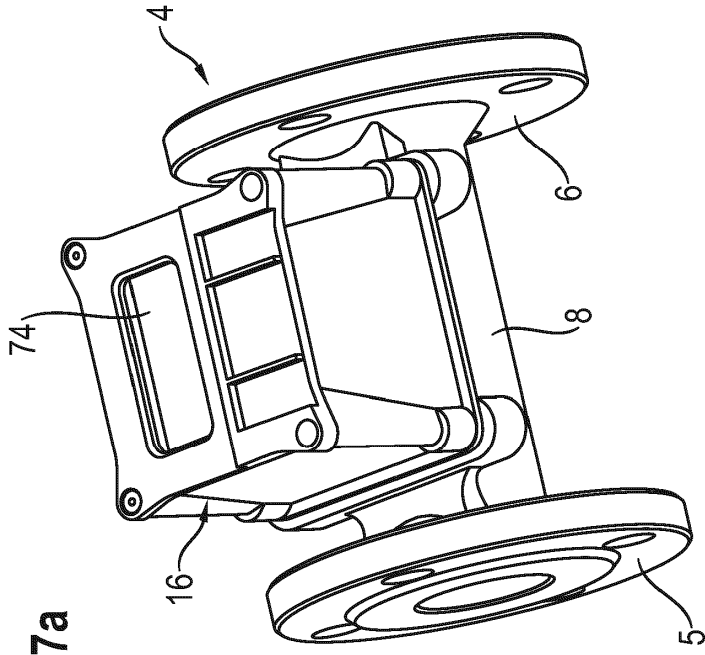


**Fig. 6a**



**Fig. 6b**

**Fig. 7a**



**Fig. 7b**

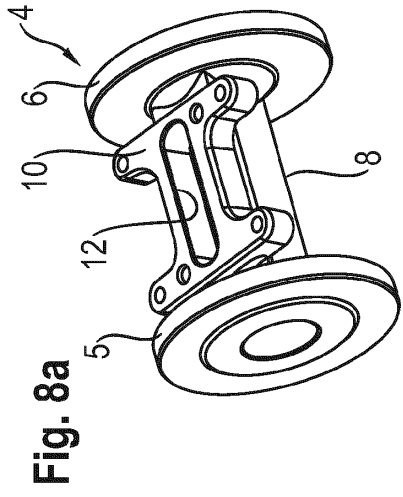


Fig. 8b

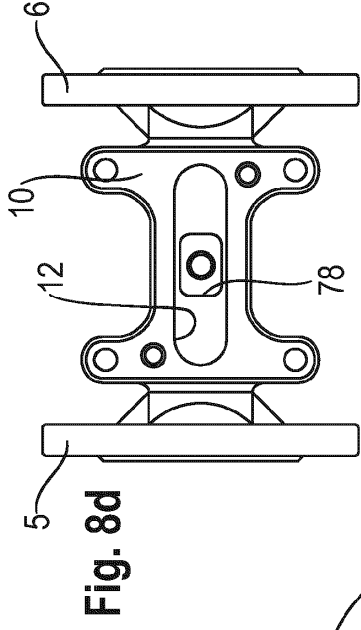
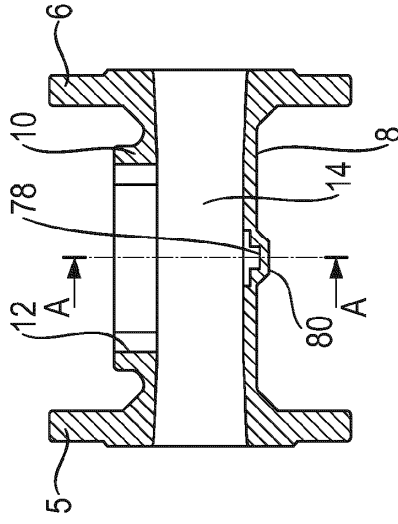


Fig. 8d

Fig. 8c

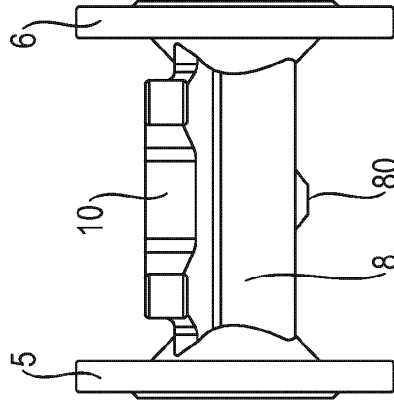
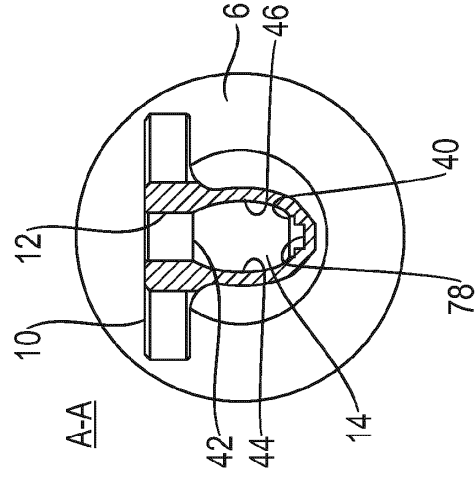
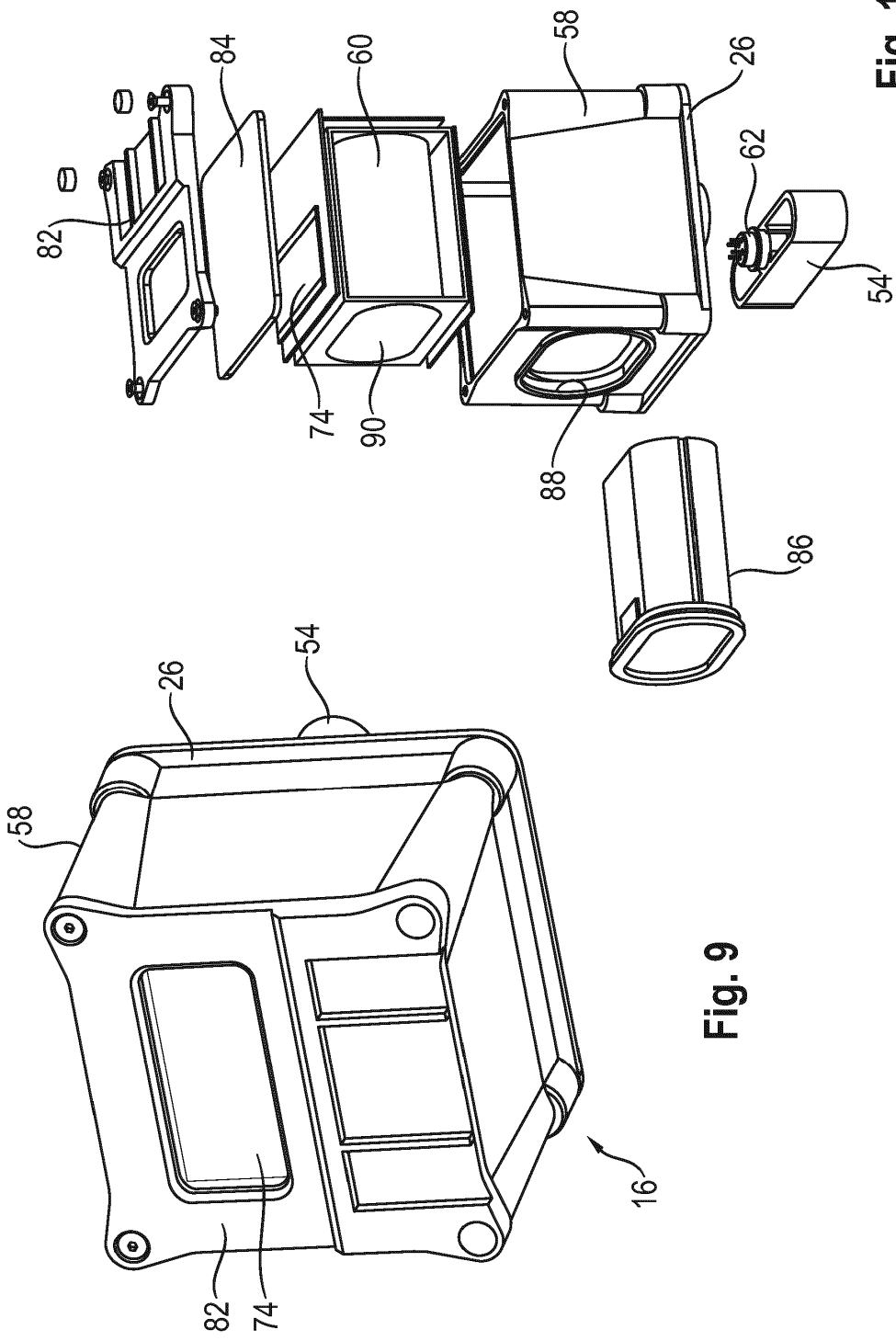


Fig. 8e



**Fig. 10**

**Fig. 9**

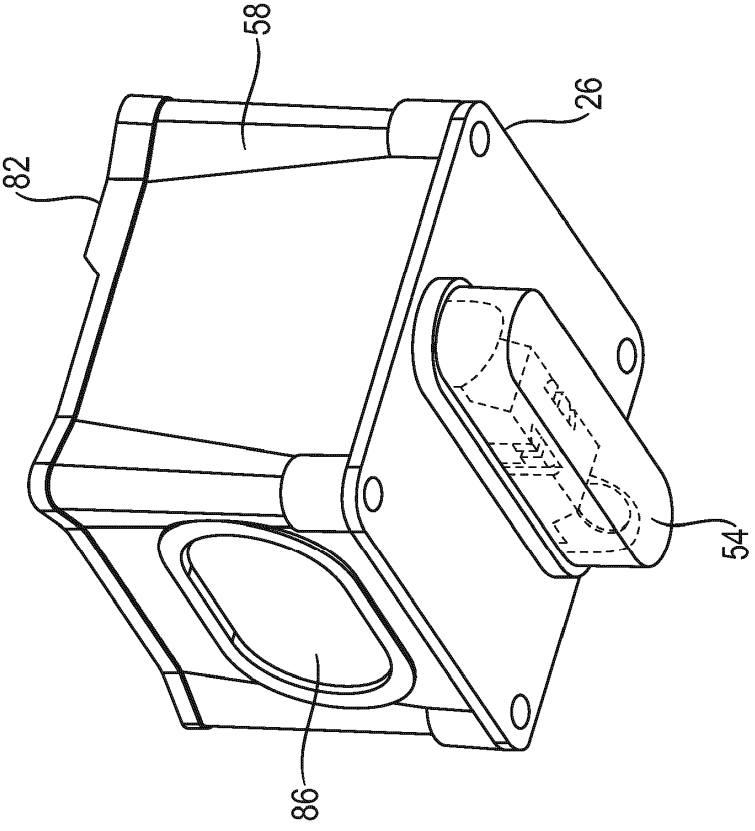
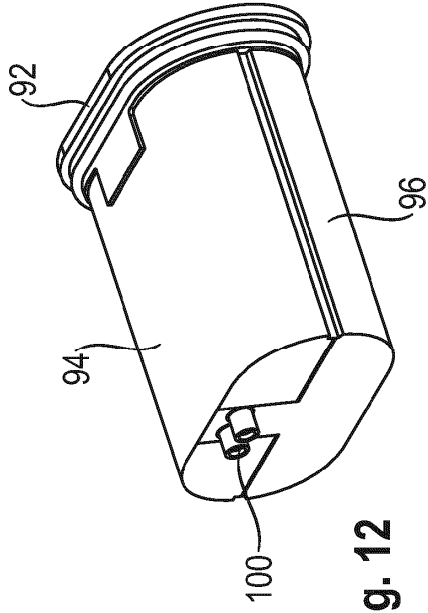
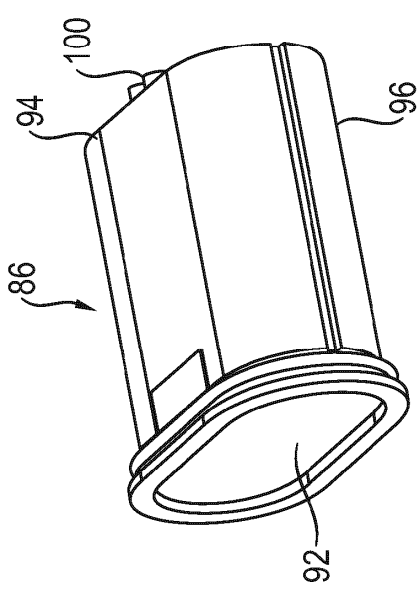
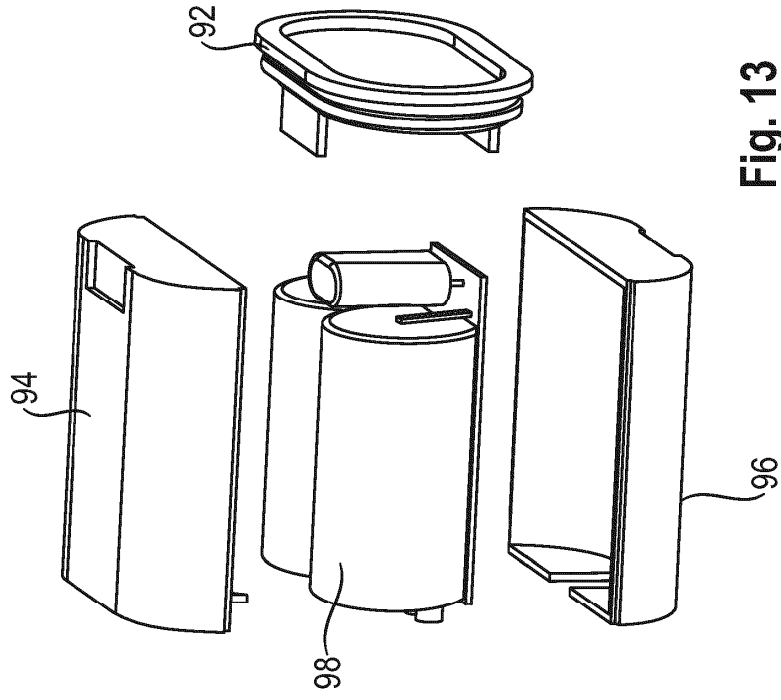


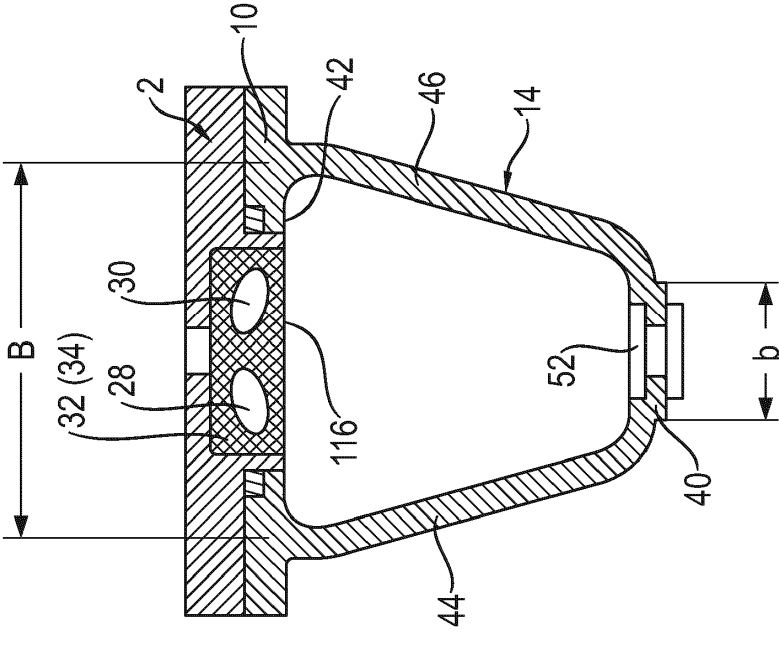
Fig. 11



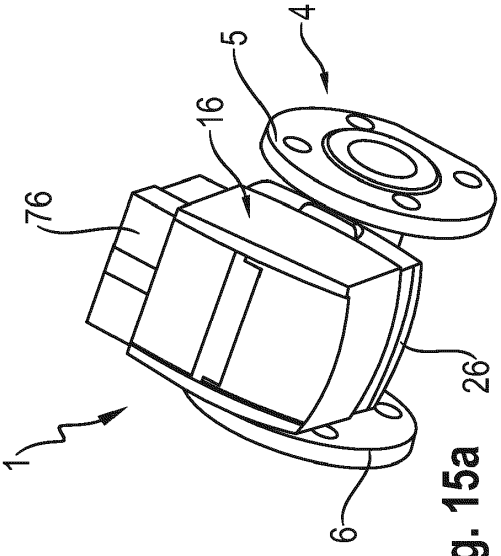
**Fig. 12**



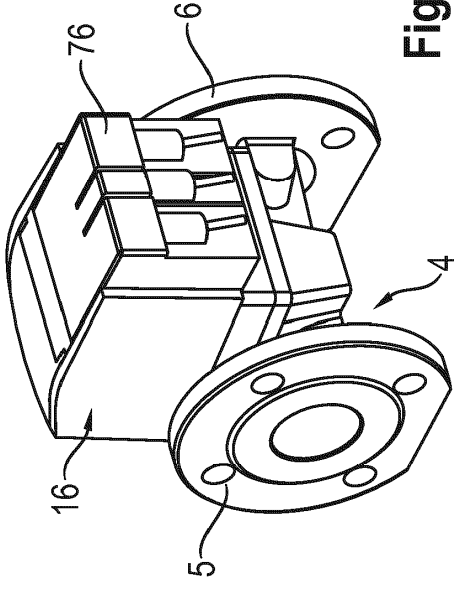
**Fig. 13**



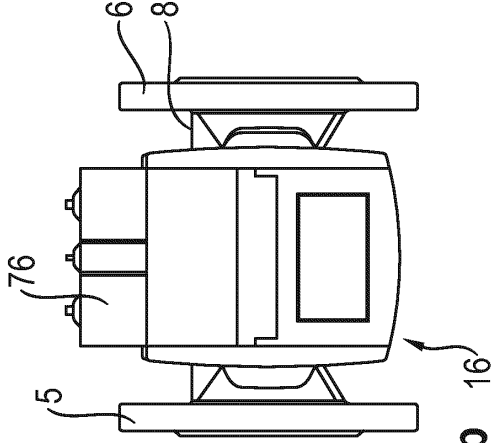
**Fig. 14**



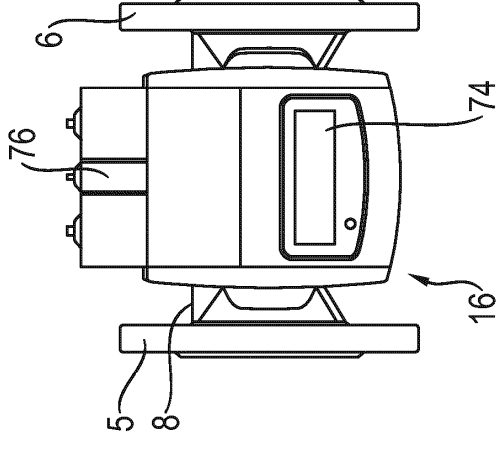
**Fig. 15a**



**Fig. 15c**

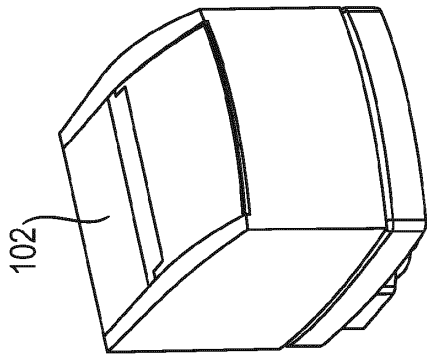


**Fig. 15b**

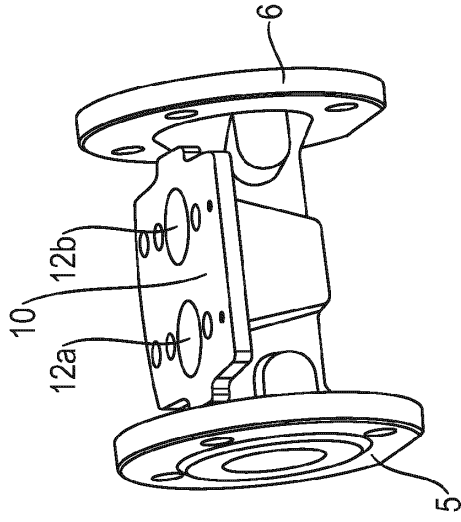


**Fig. 15d**

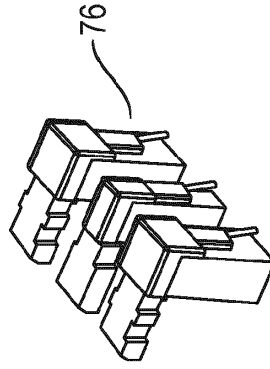
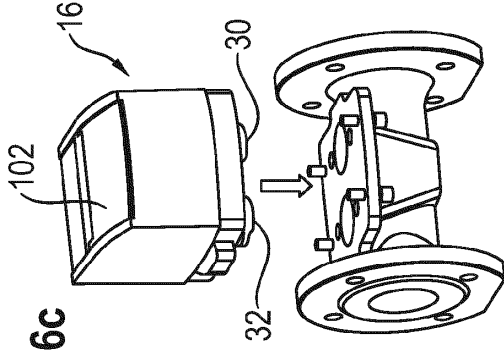
**Fig. 16a**



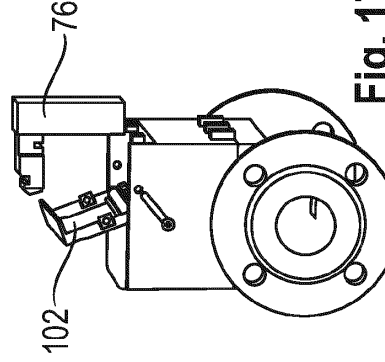
**Fig. 16b**



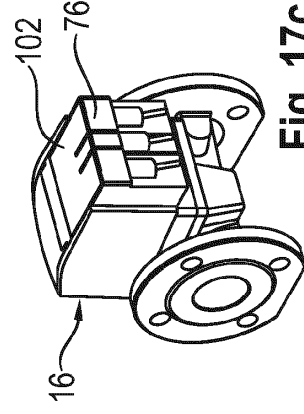
**Fig. 16c**



**Fig. 17a**



**Fig. 17b**



**Fig. 17c**

Fig. 18a

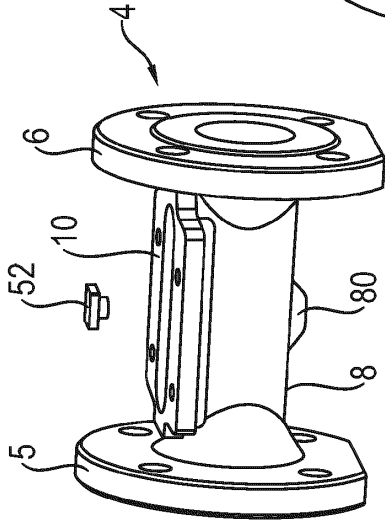


Fig. 19a

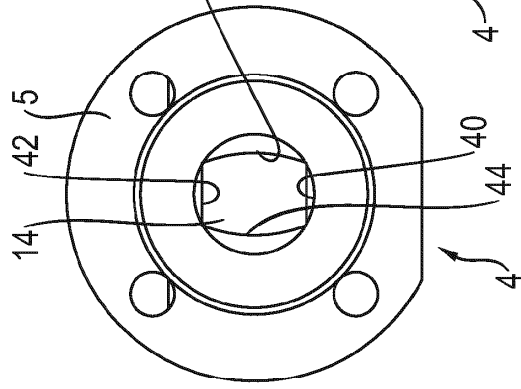
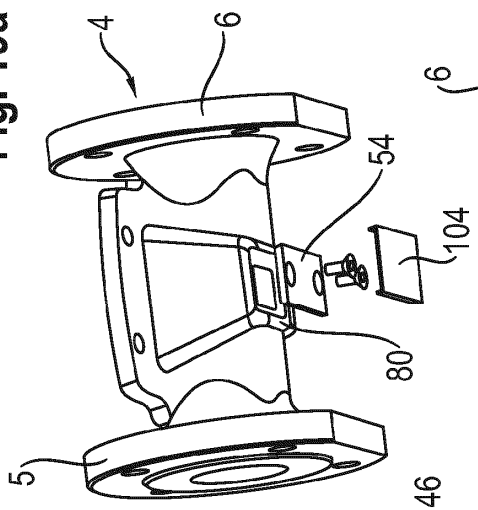


Fig. 18b

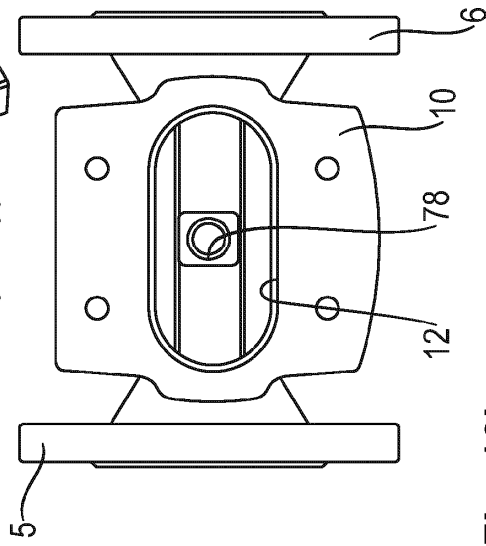
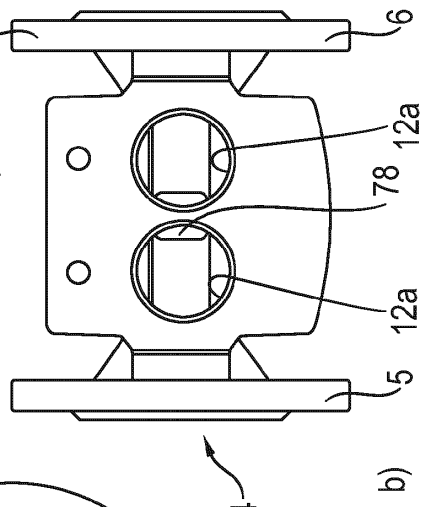
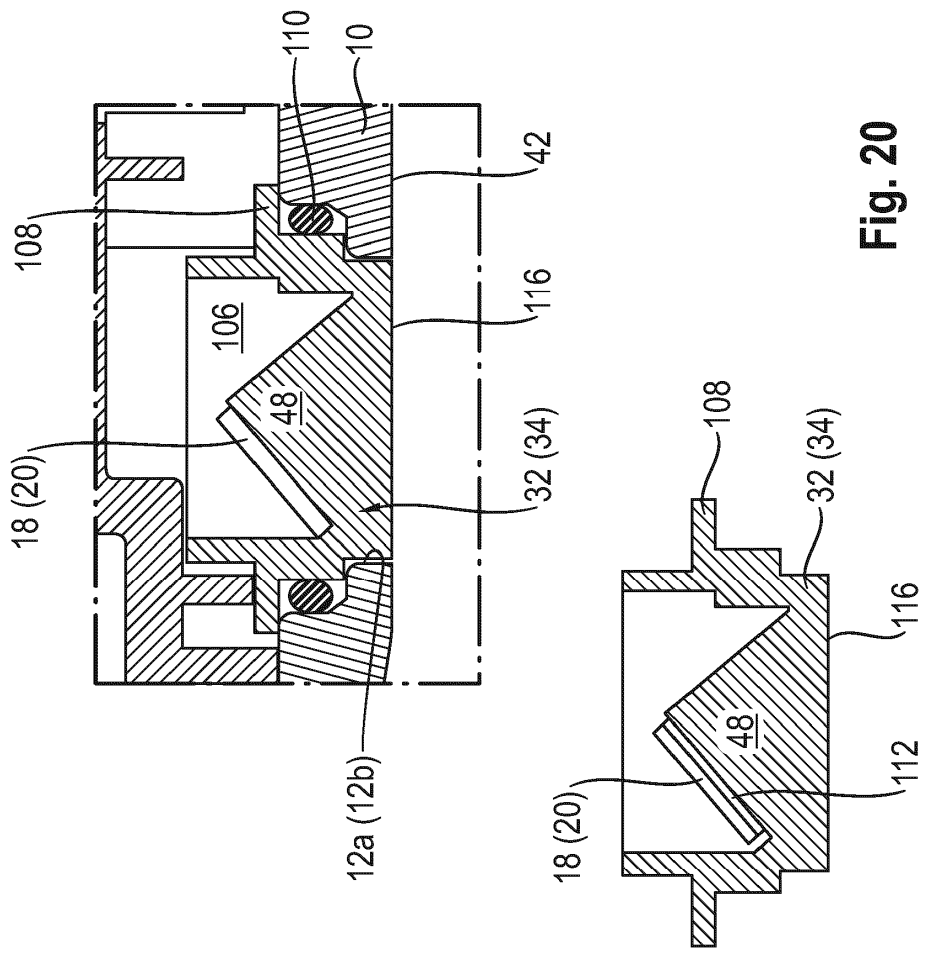


Fig. 19b





**Fig. 20**

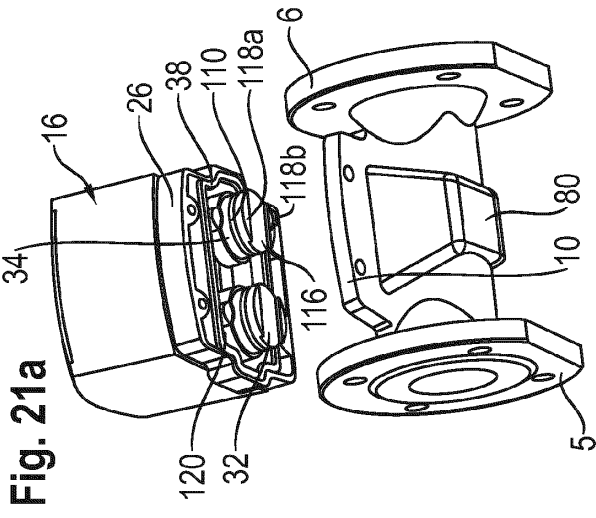


Fig. 21a

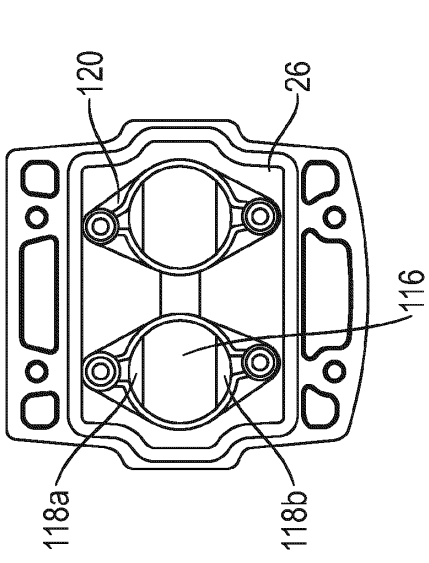


Fig. 21c

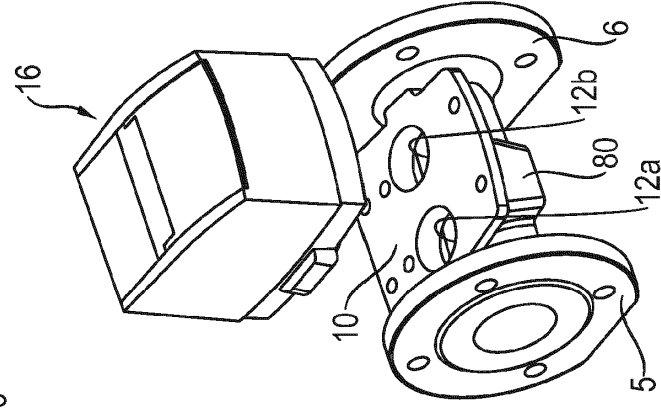


Fig. 21b

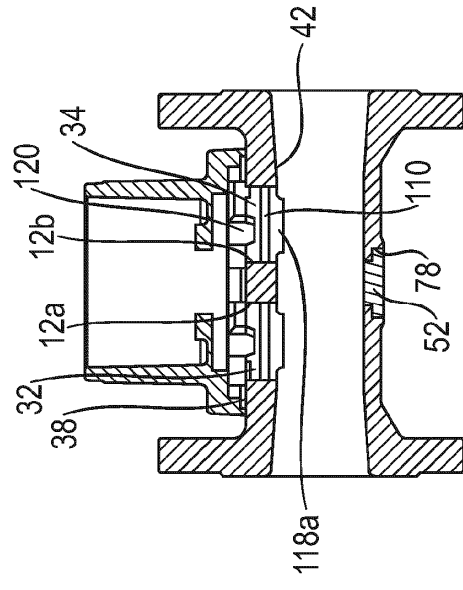
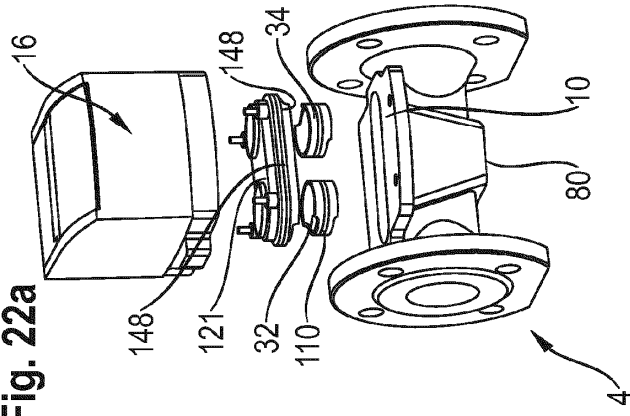
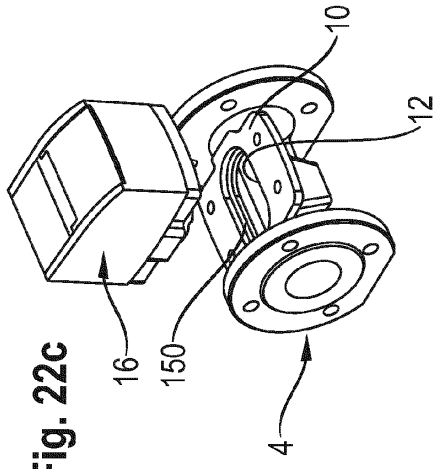


Fig. 21d

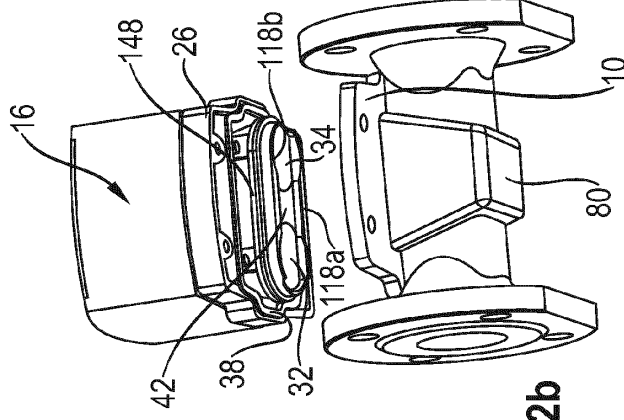
**Fig. 22a**



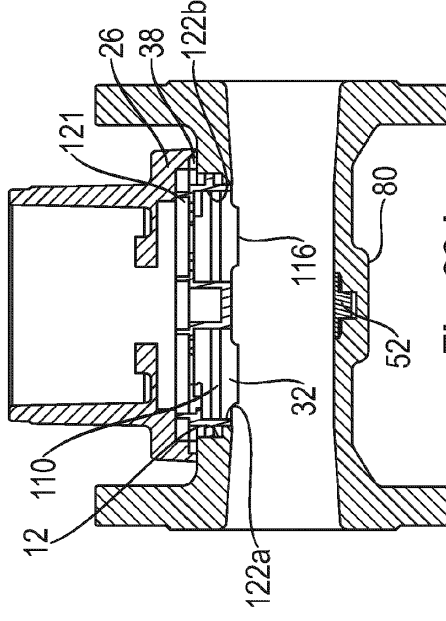
**Fig. 22c**



**Fig. 22b**



**Fig. 22d**



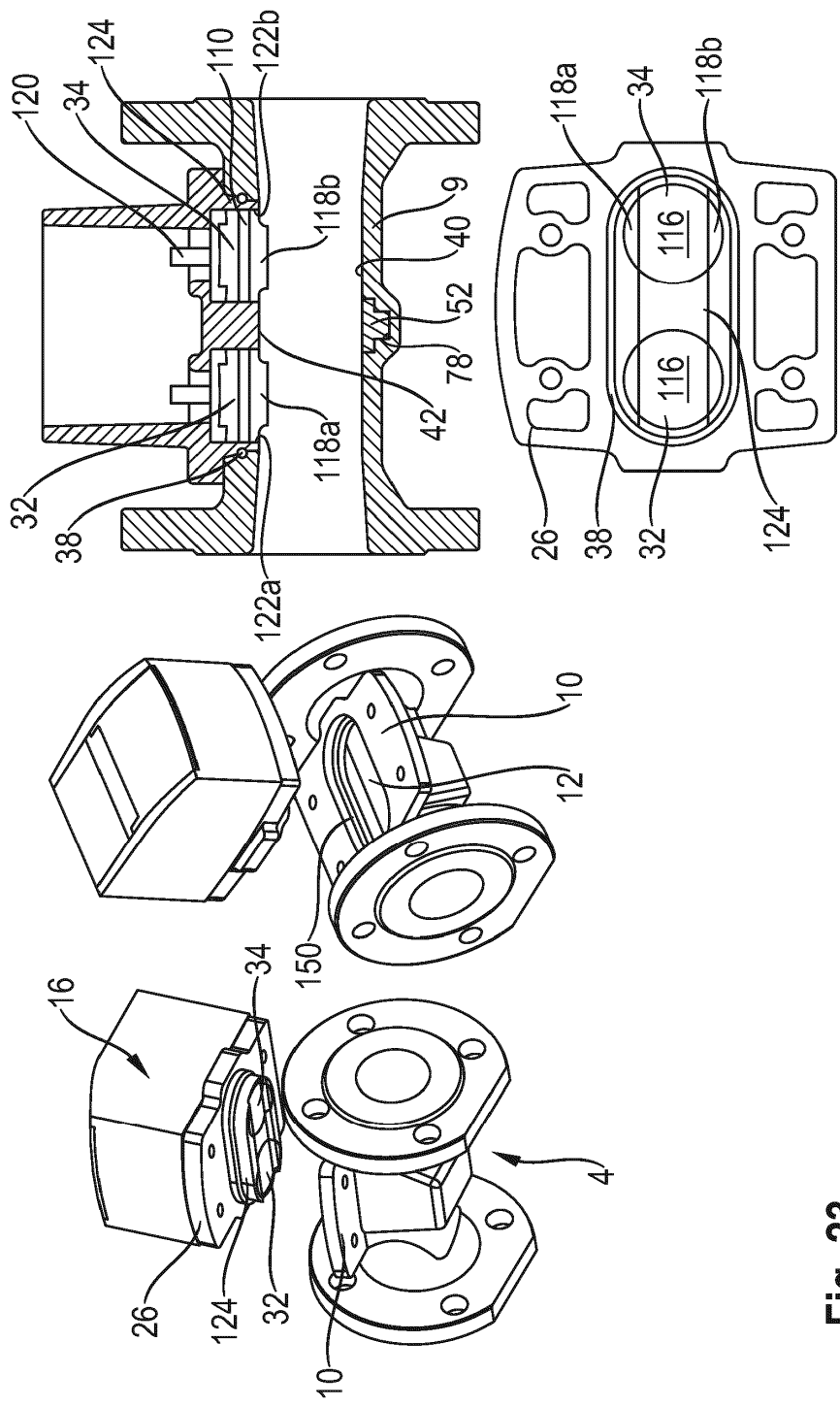


Fig. 23

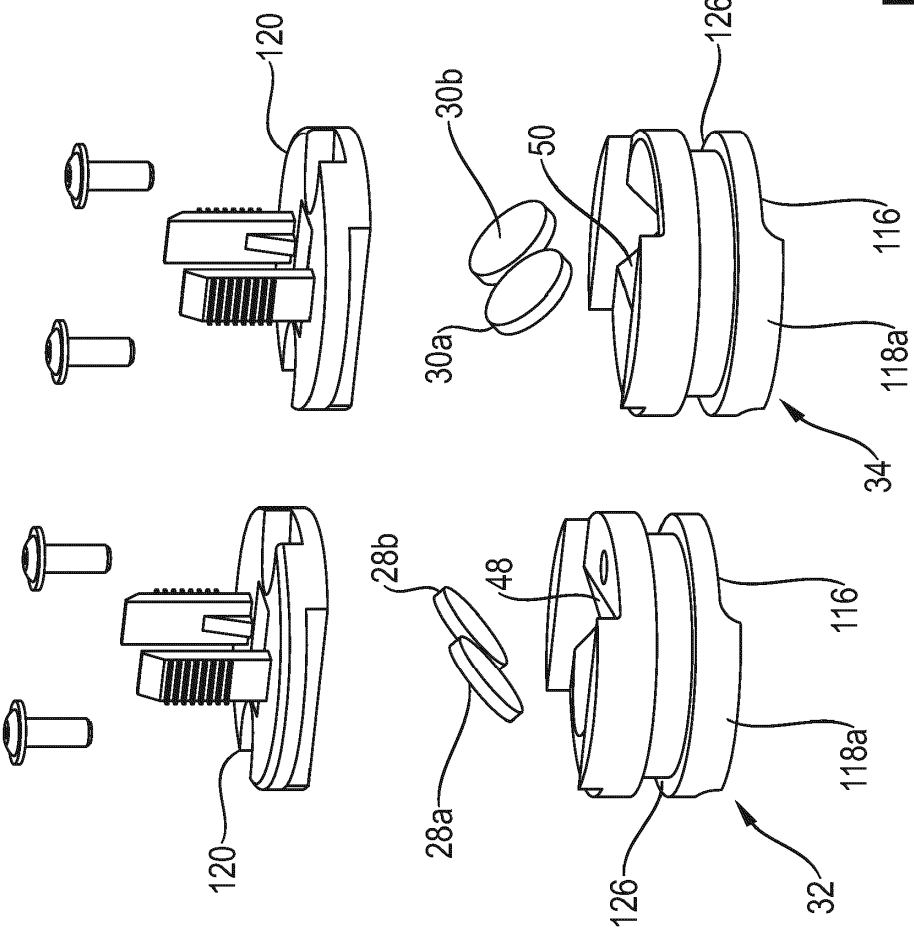
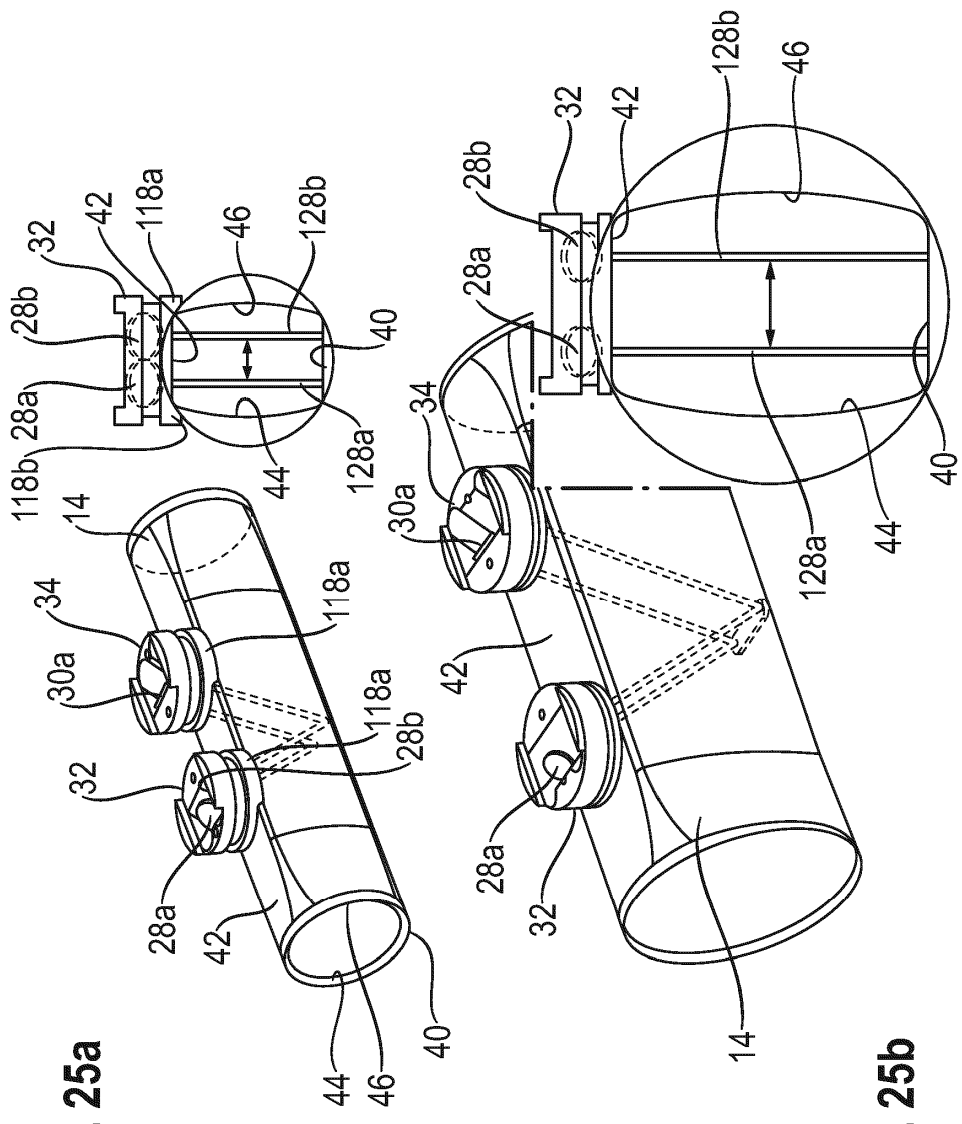


Fig. 24



**Fig. 25a**

**Fig. 25b**

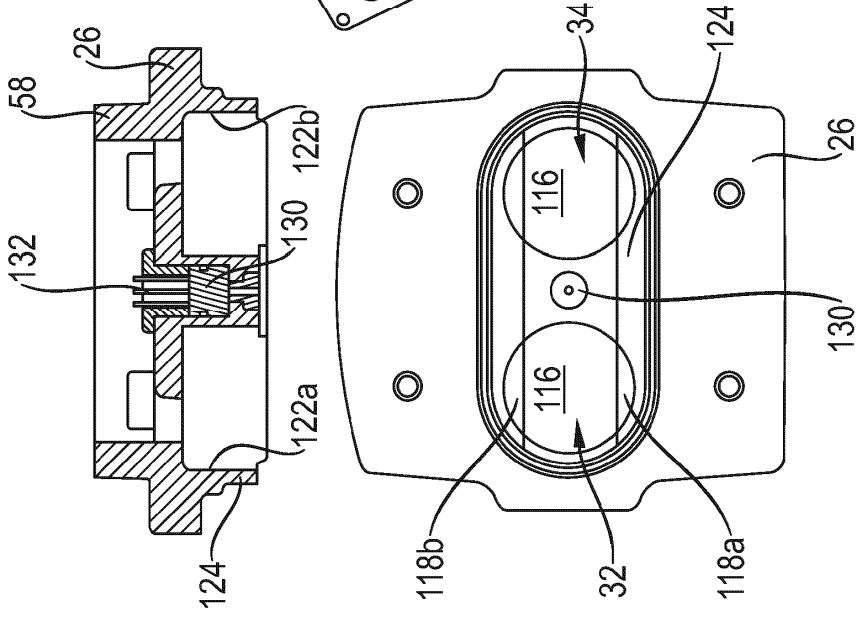


Fig. 26a

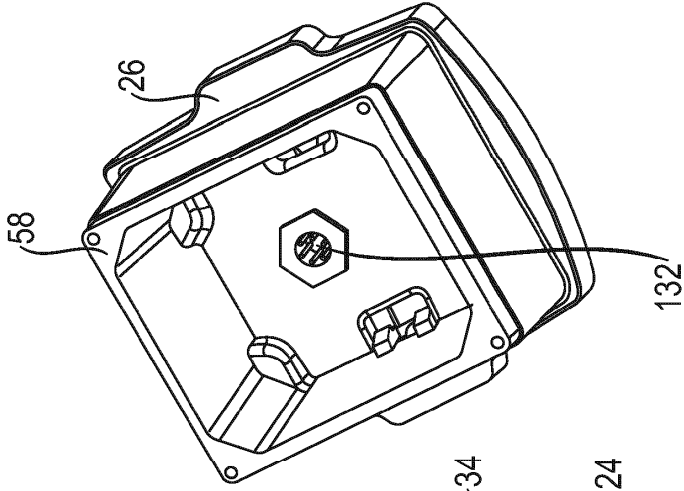


Fig. 26b

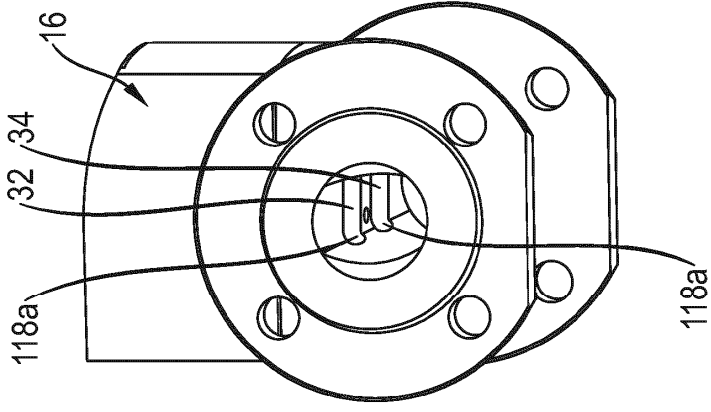


Fig. 26c

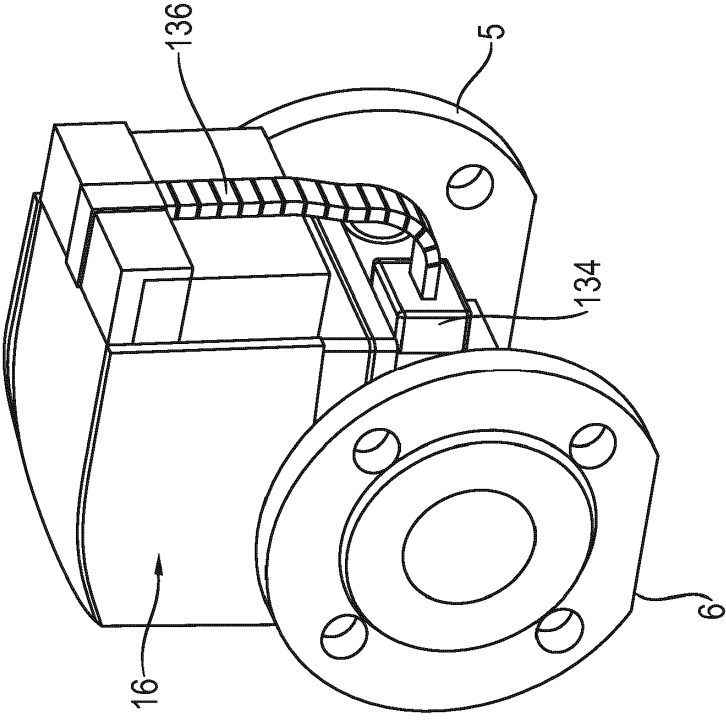


Fig. 27b

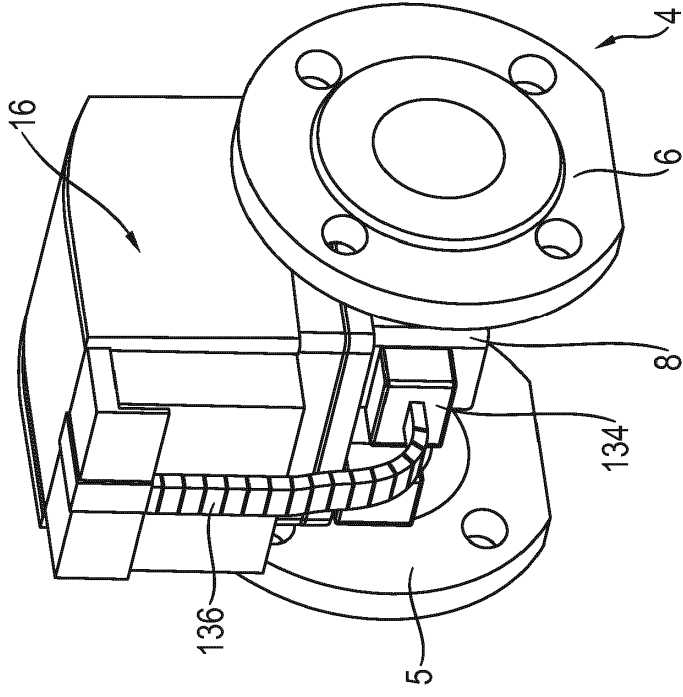


Fig. 27a

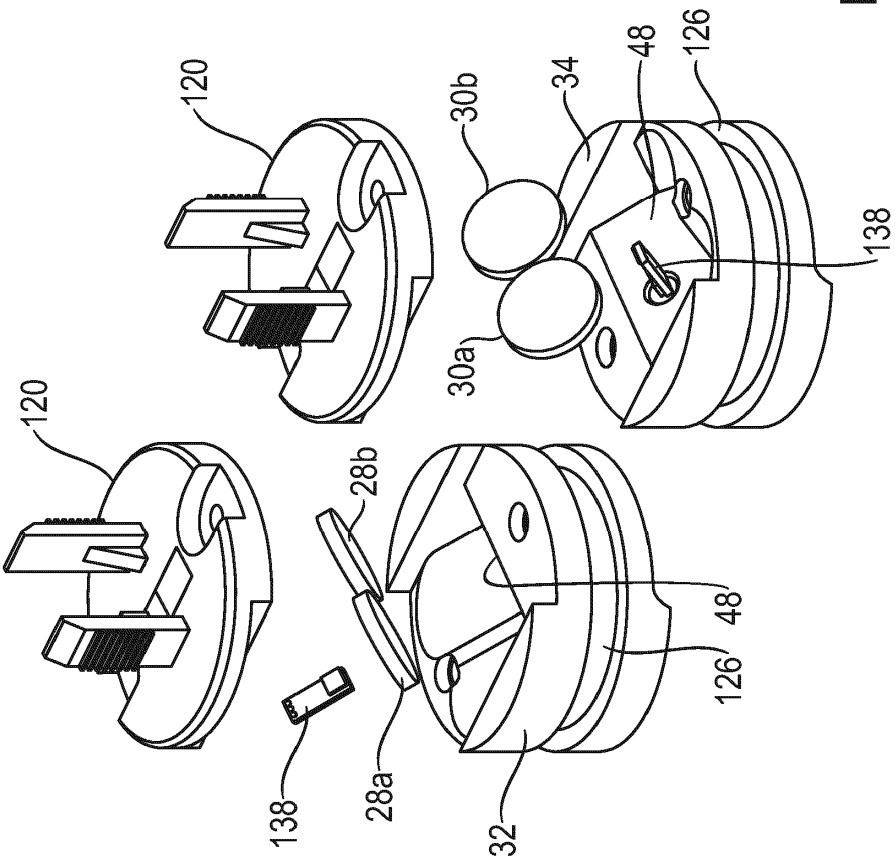
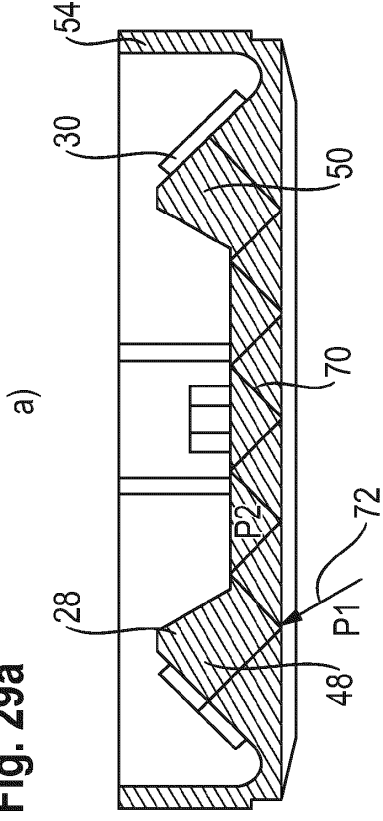
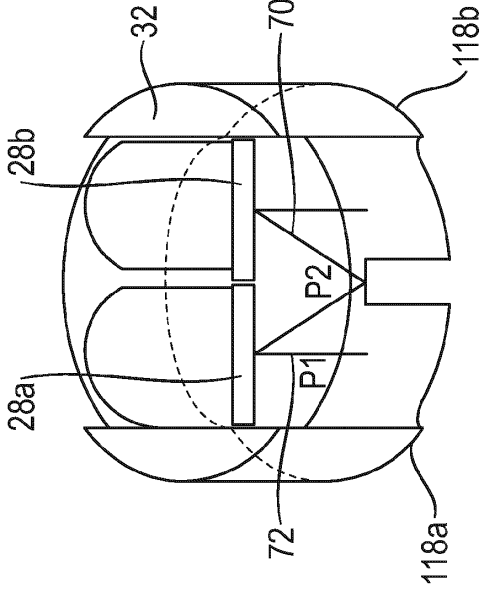


Fig. 28

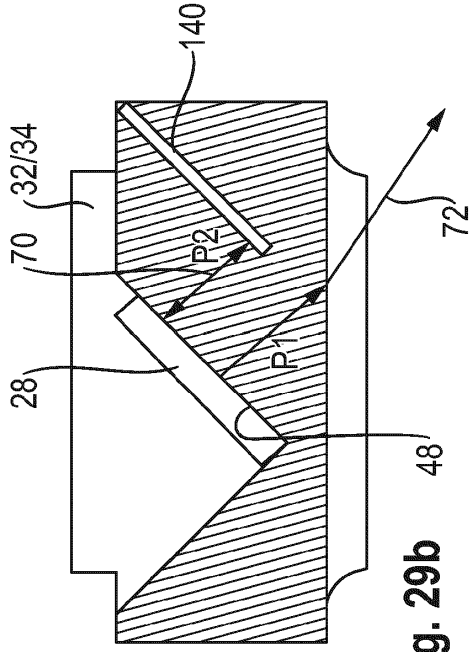
**Fig. 29a**



**Fig. 29c**



**Fig. 29b**



**Fig. 29d**

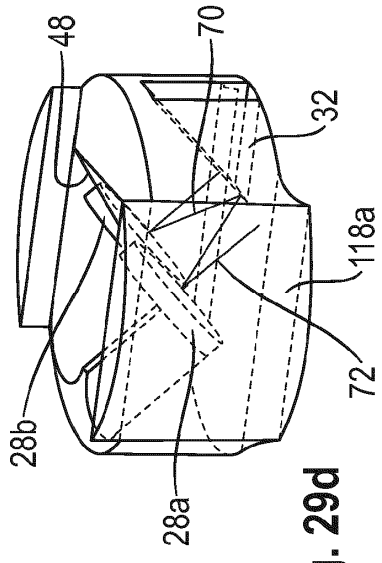


Fig. 30a

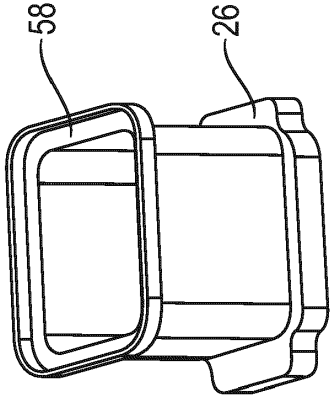
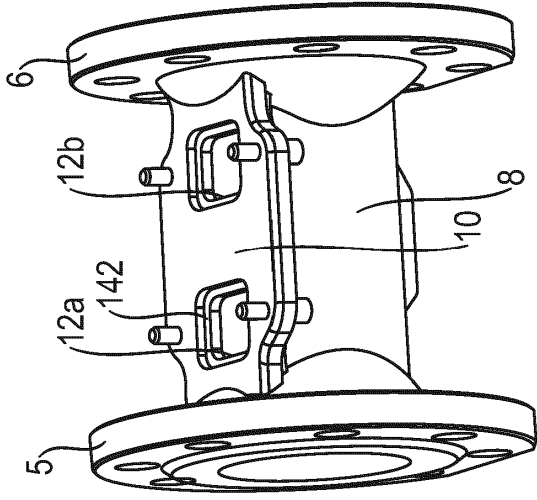
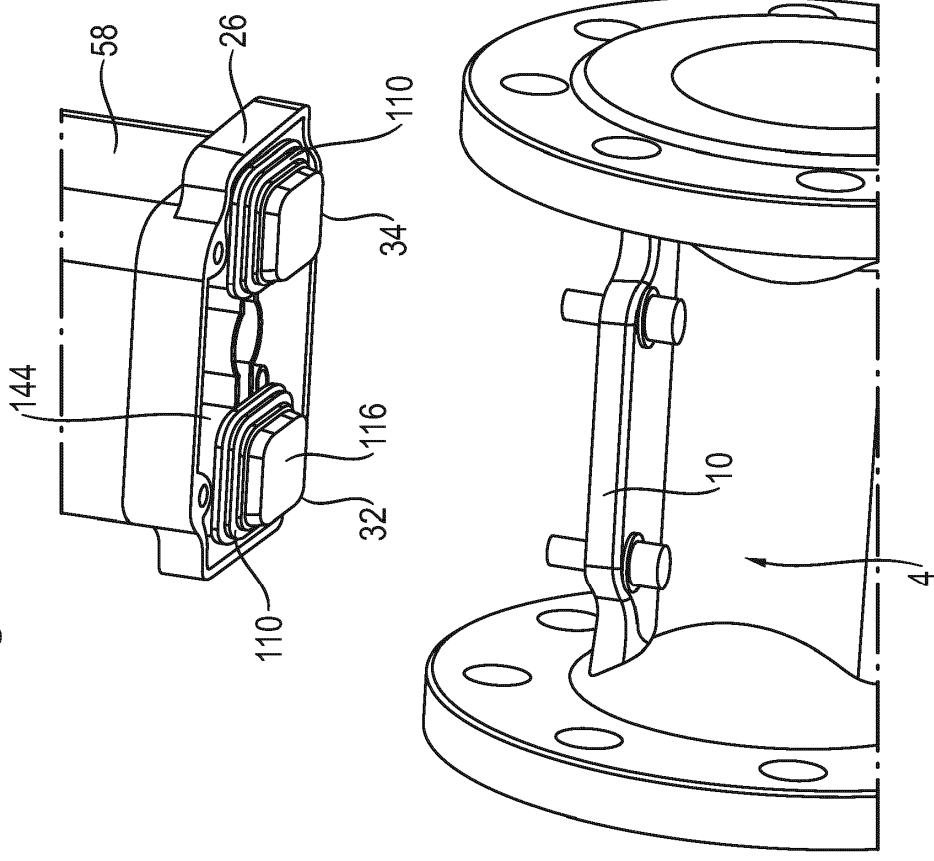
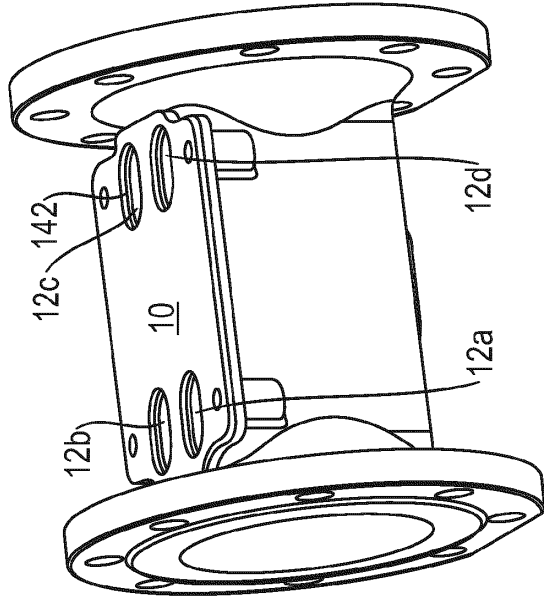
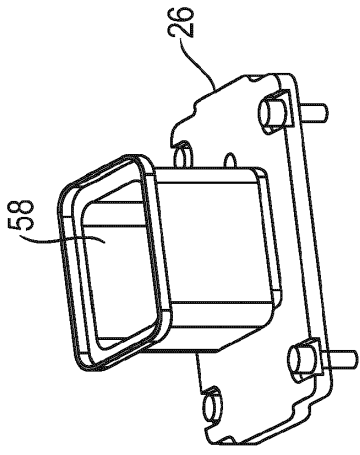
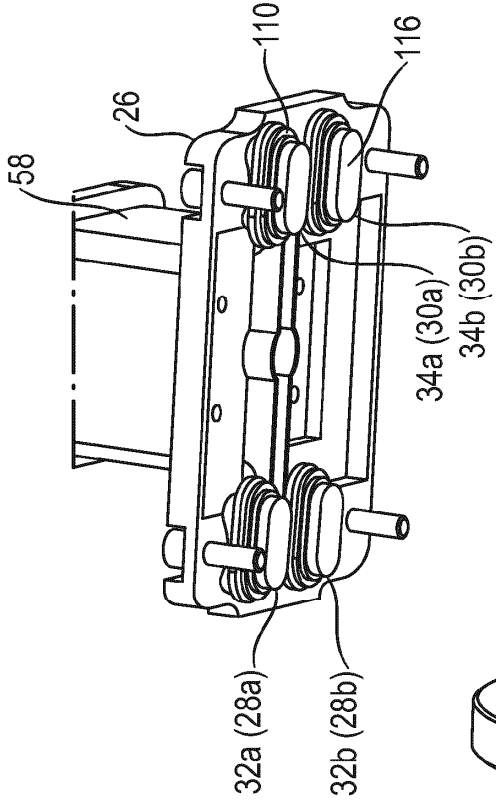


Fig. 30b





**Fig. 31a**



**Fig. 31b**

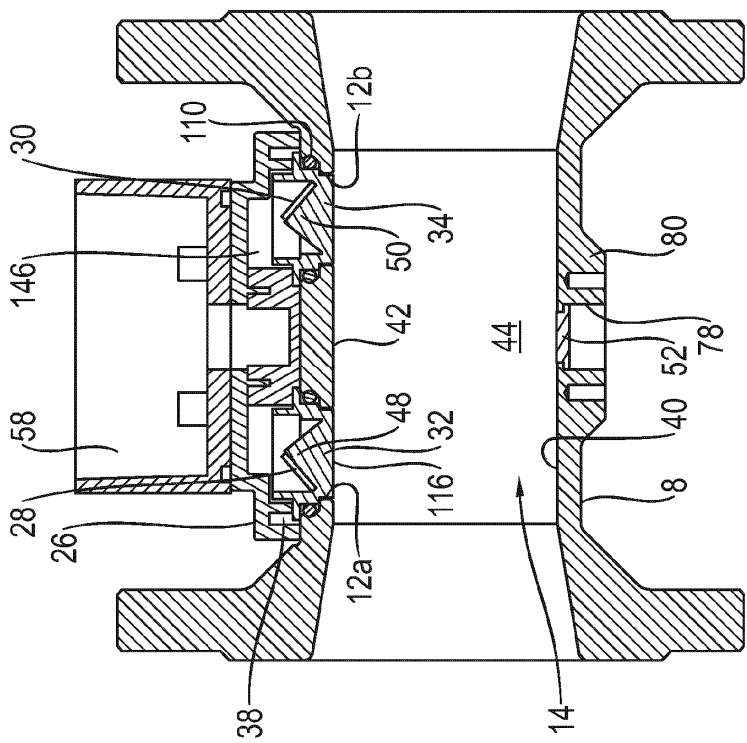


Fig. 32a

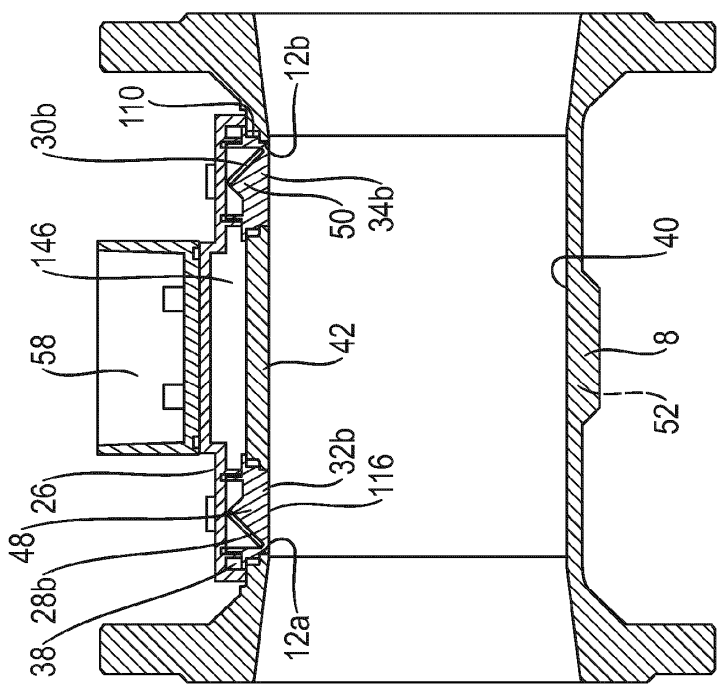


Fig. 32b